



Spatial Agency:

Rethinking Informal Architecture

BOYA CHAO + DHVANI DOSHI



In Mumbai, streets typically used for transportation and circulation have also transformed into living or working for lower-income communities. The vibrancy of the street life and activity has become an integral part of the city; both the local residents and the street workers depend on these informal businesses in their daily lives. However, the timeliness and the urgency of the thriving micro-culture is being discouraged by the government because of difficulties in monitoring taxation and sales as well as the limited affordable spaces for these businesses.

By leveraging spatial agency and other ways of doing architecture, this thesis acknowledges the perspectives of all users of the streets to design an intervention for the city of Mumbai. It will present ways for the city to thrive and satisfy the needs of all its users.

Analyzing the problems faced by all participant groups through the lens of the urban environment enables us to envision solutions beyond just removal of informal structures on the streets; and also opens up possibilities of creating innovative urban spaces through a co-constitutive process that would benefit all the co-inhabitants of the city. This thesis aims to legitimize the informal illegal structures by infiltrating and expanding street activity into the existing urban context using intermittent infrastructural systems that integrate the dynamic street life into the built environment.

open air

stationary

enclosed structure



on foot

itinerant

on wheels

types of hawkers

tarpaulin



wood



corrugated metal



found materials

bamboo sticks

plastic / cane

bricks

assemblage analysis

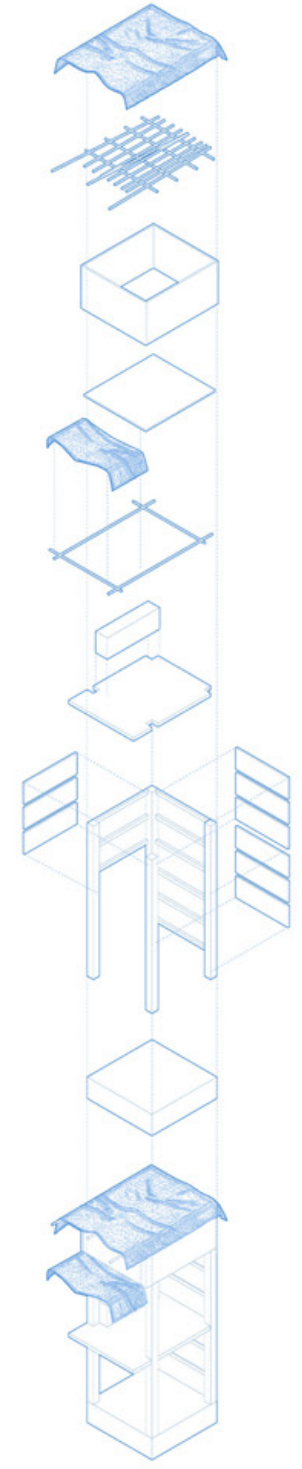
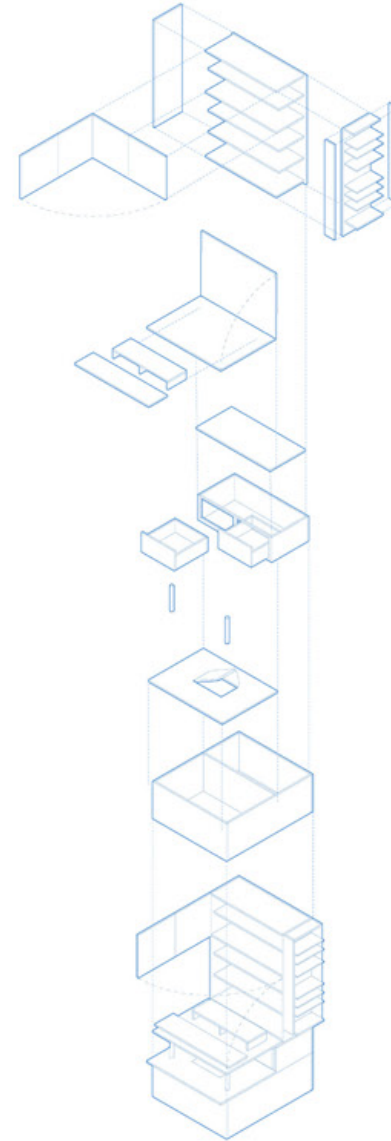
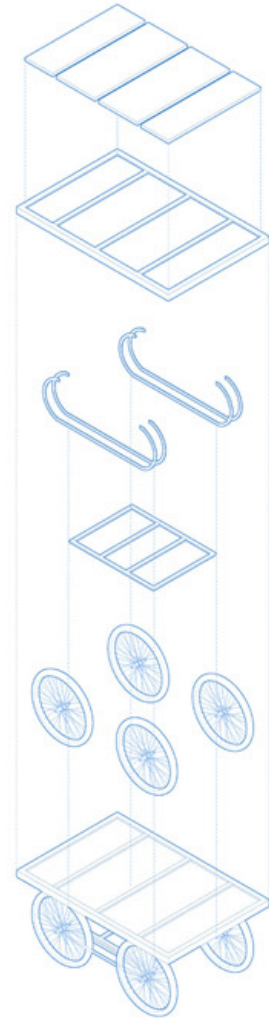
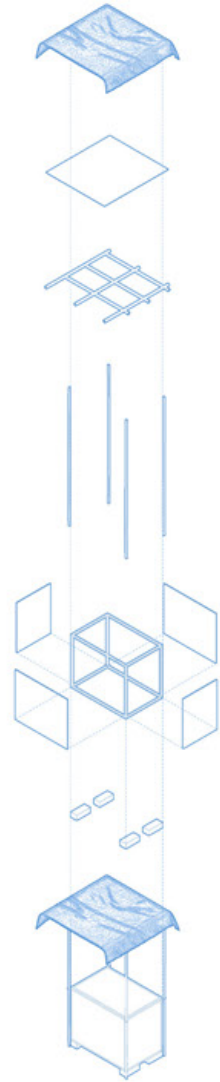
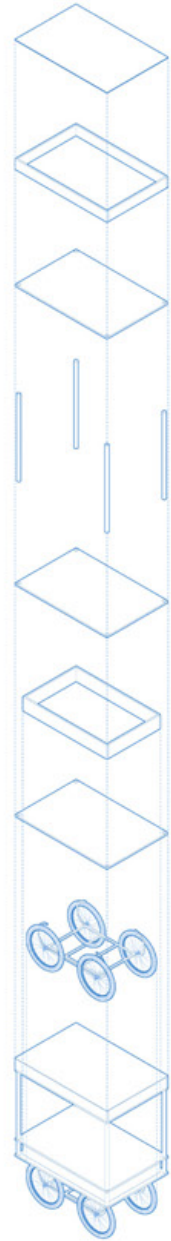
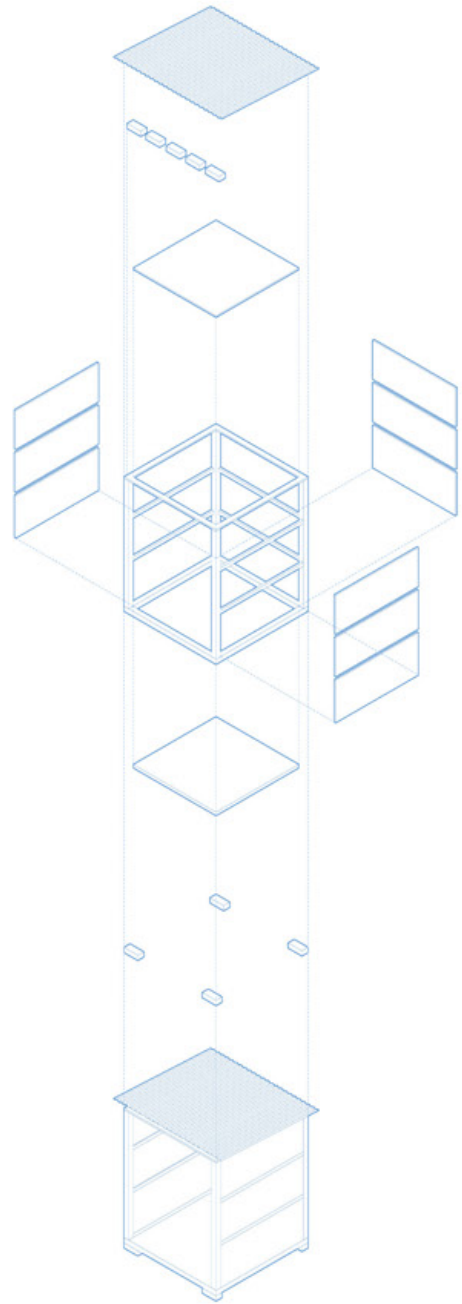

found objects on site

repurposed found space and object

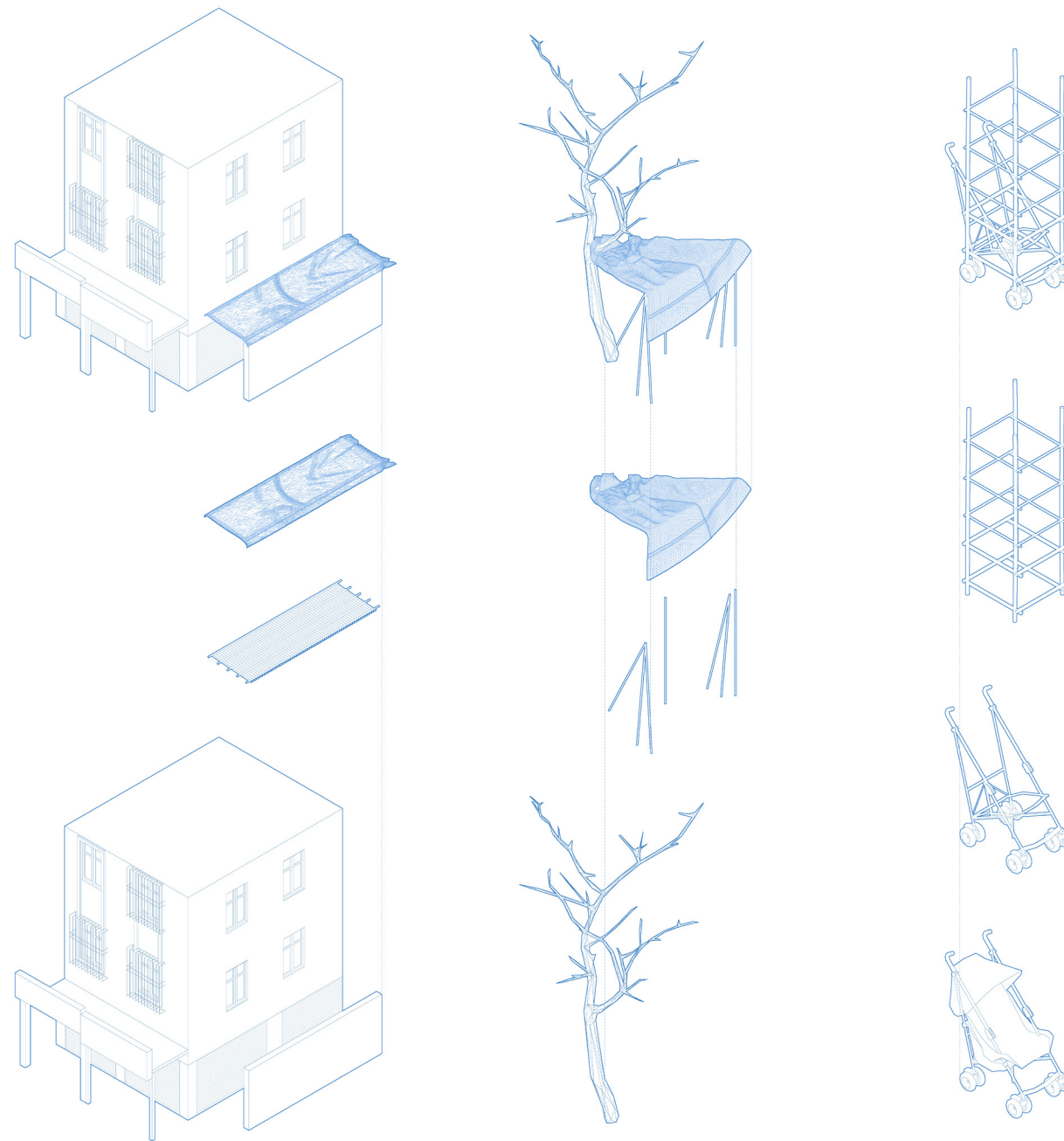

found objects on site

piling



stacking



layering



hanging



scattering

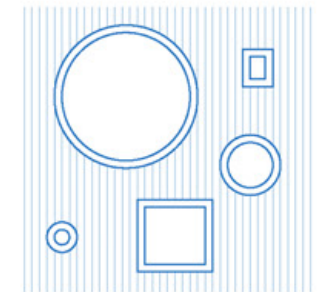
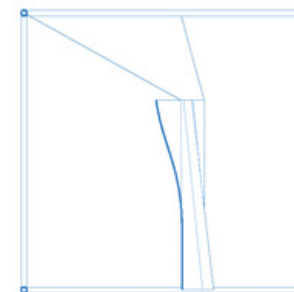
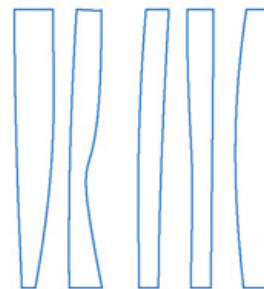
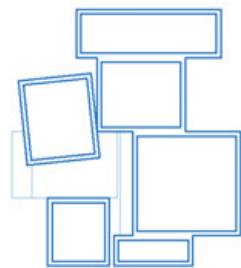
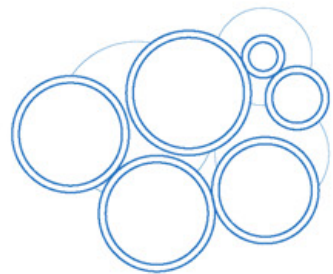
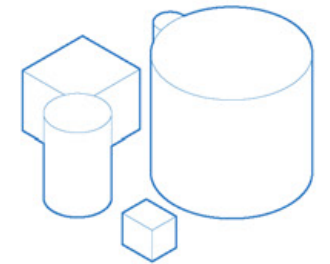
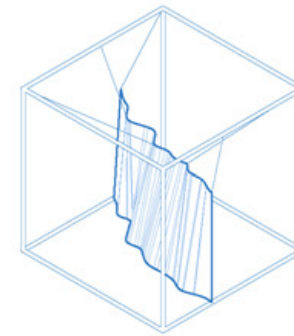
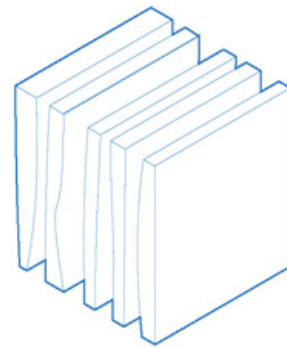
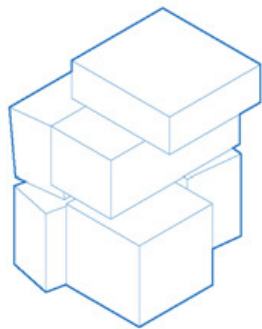
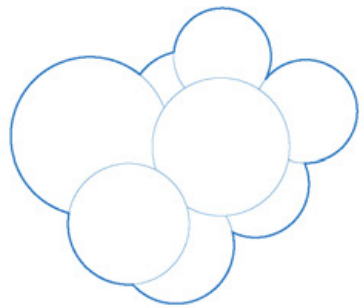

techniques of hawking

bundling



wrapping



canopying



enclosing



framing

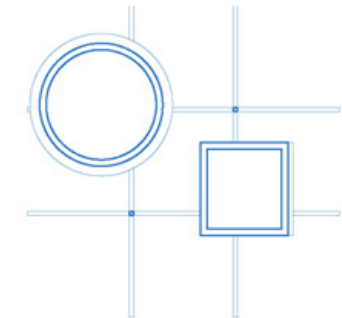
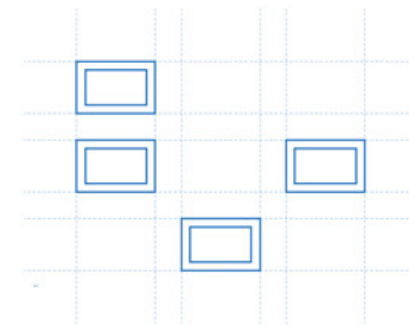
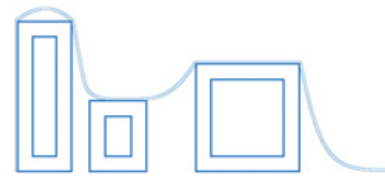
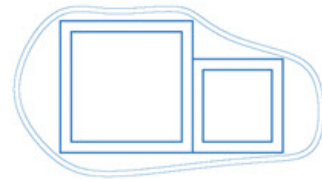
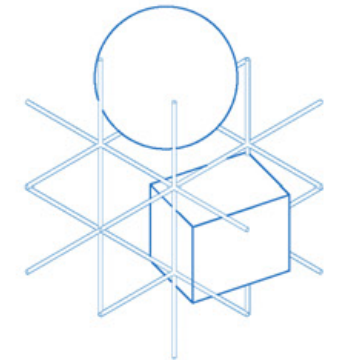
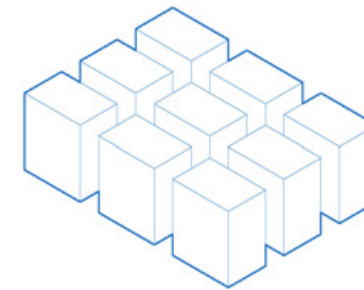
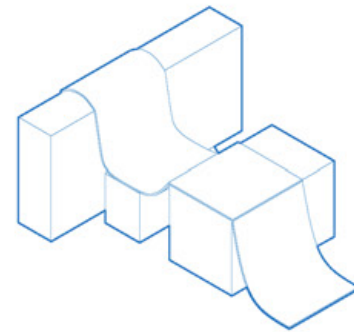
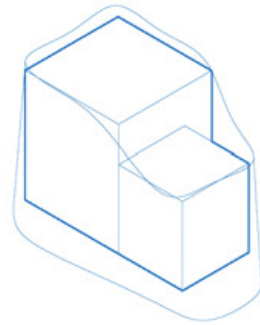
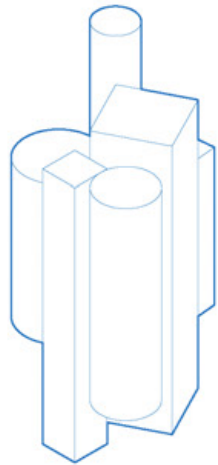

techniques of hawking

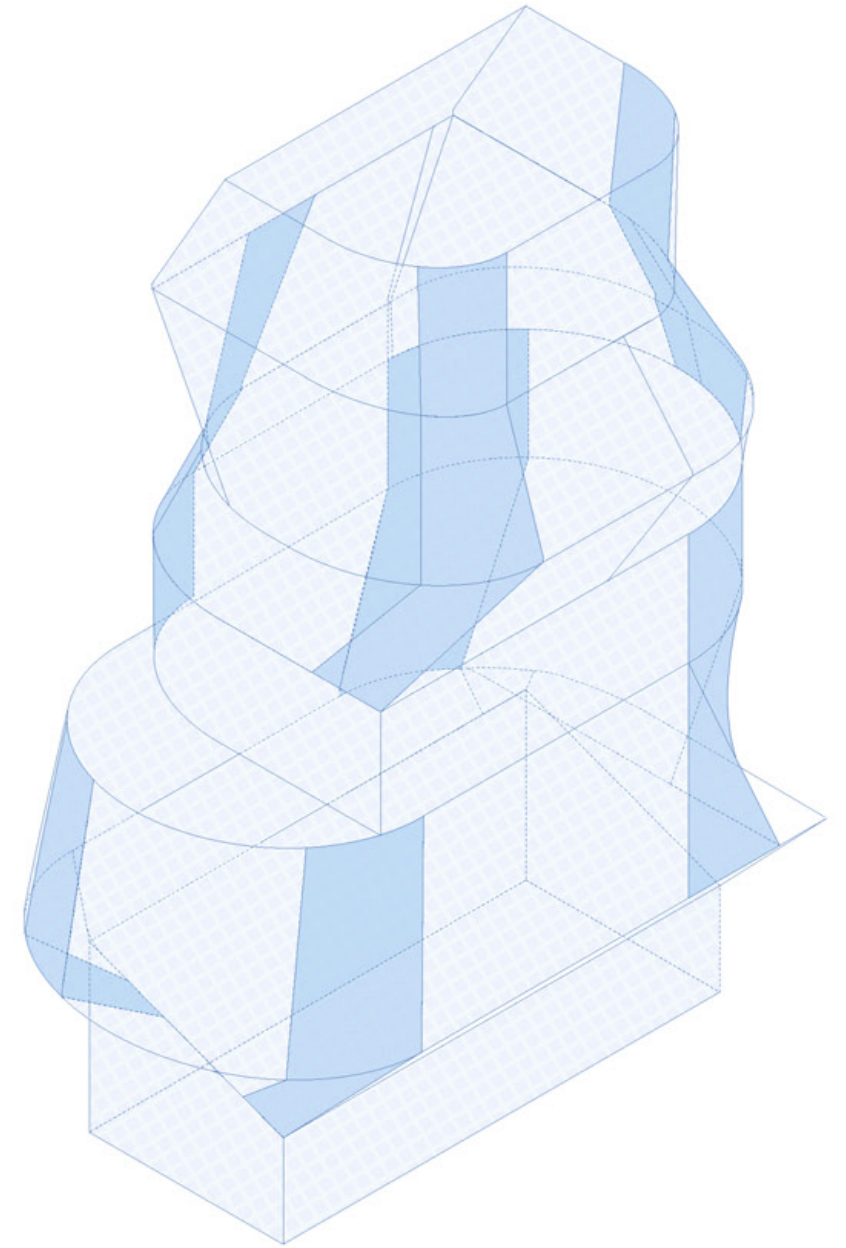
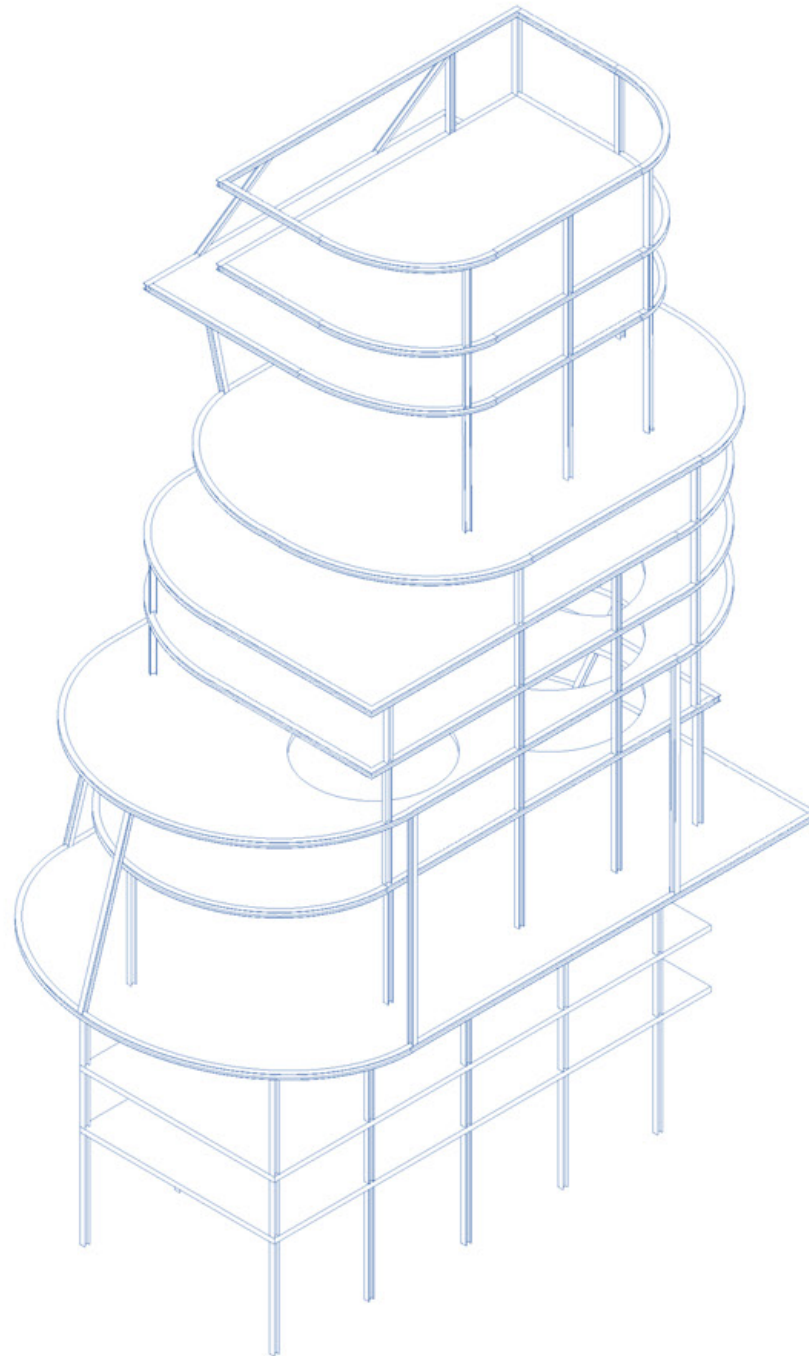
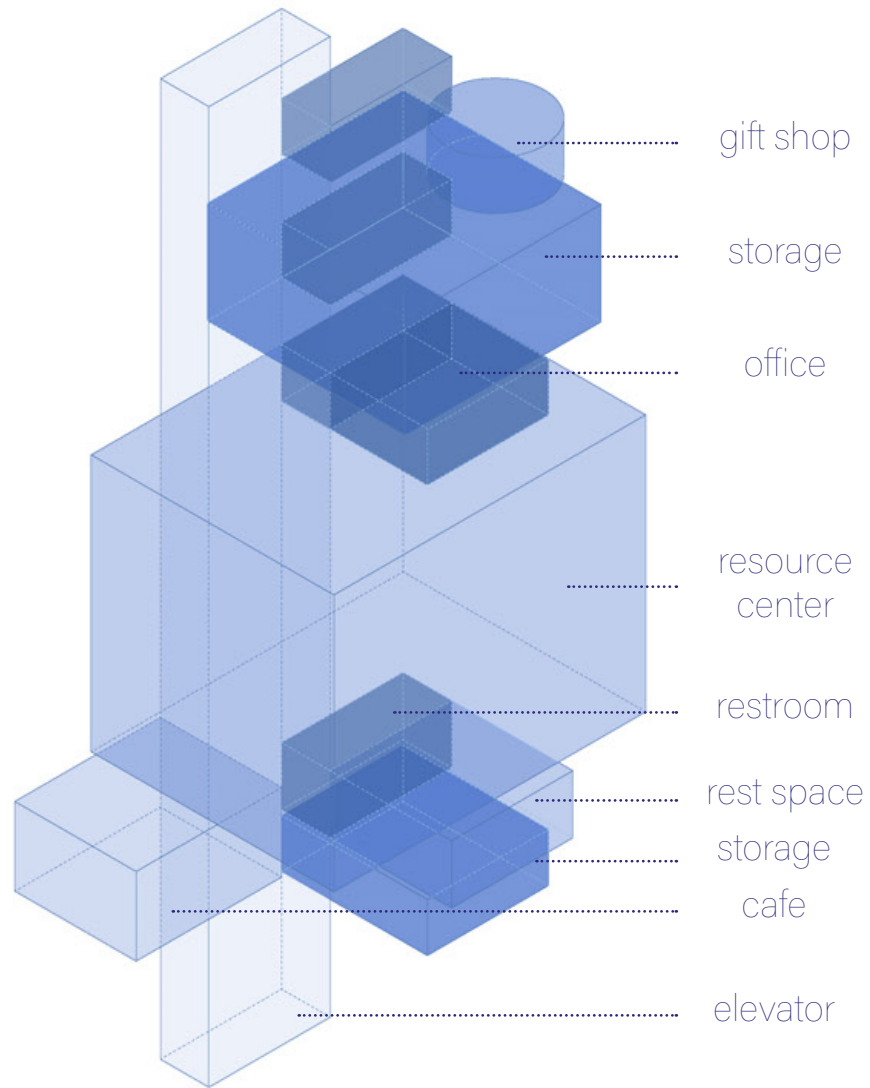

program and design

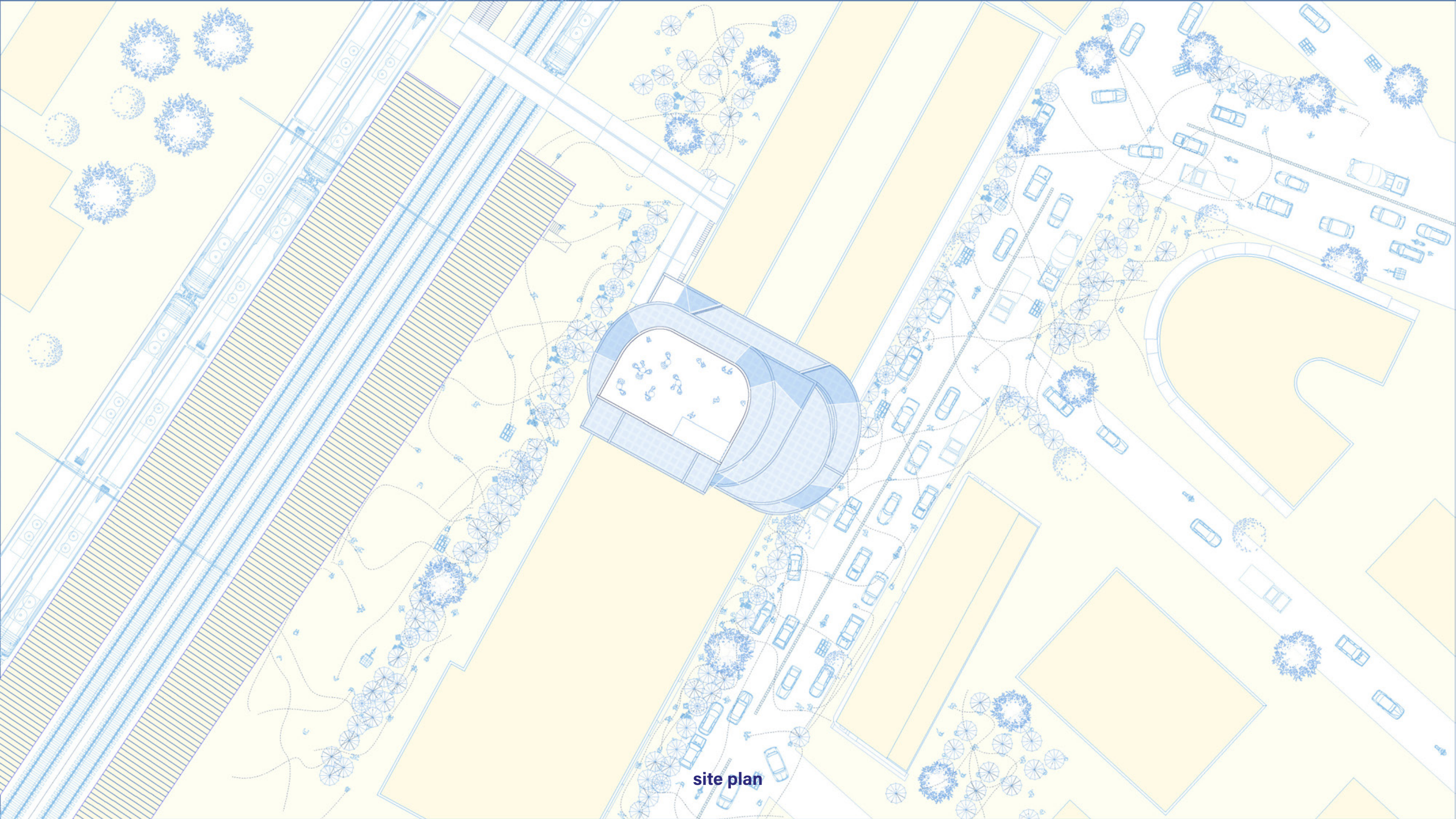

site plan



resource center plan

site elevation

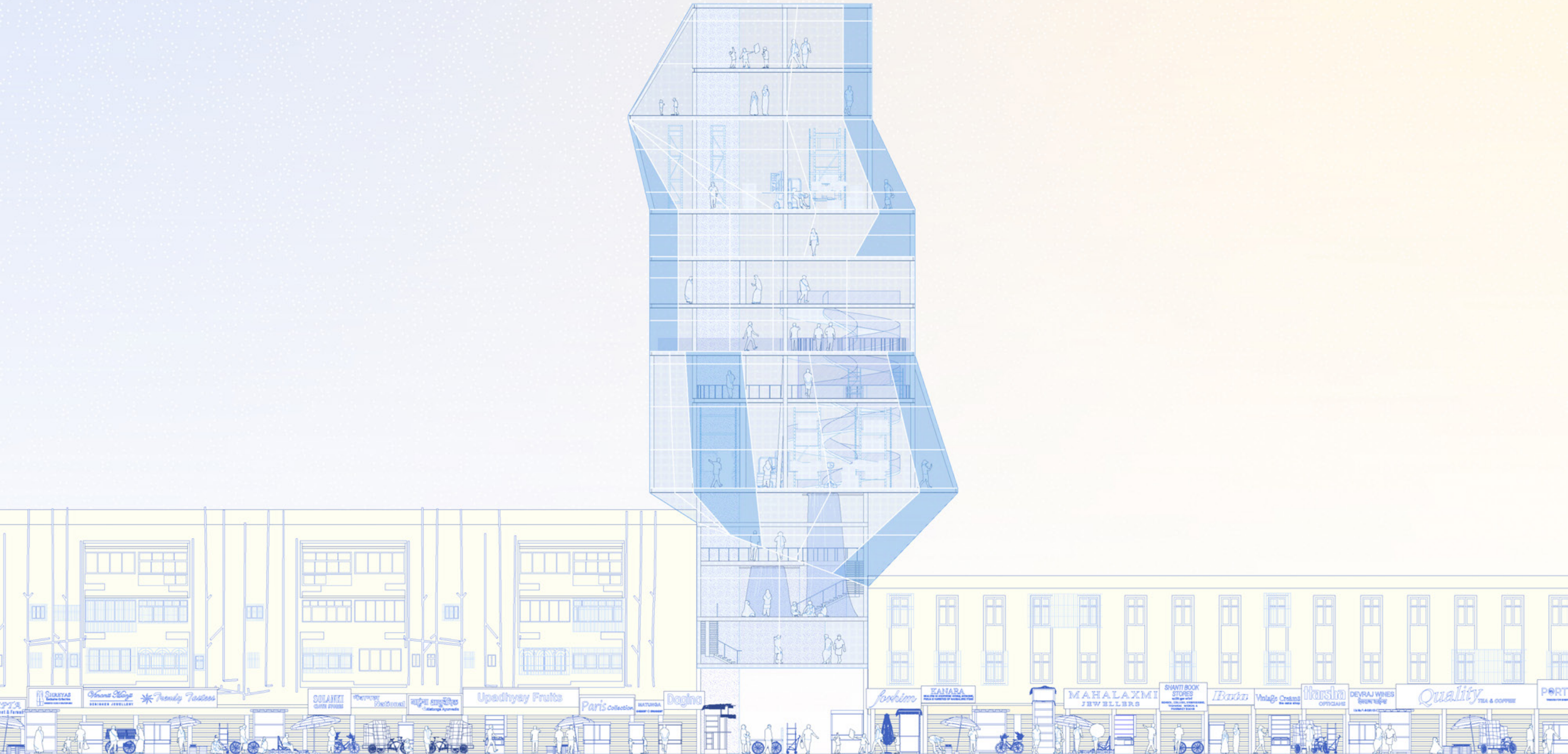

building section

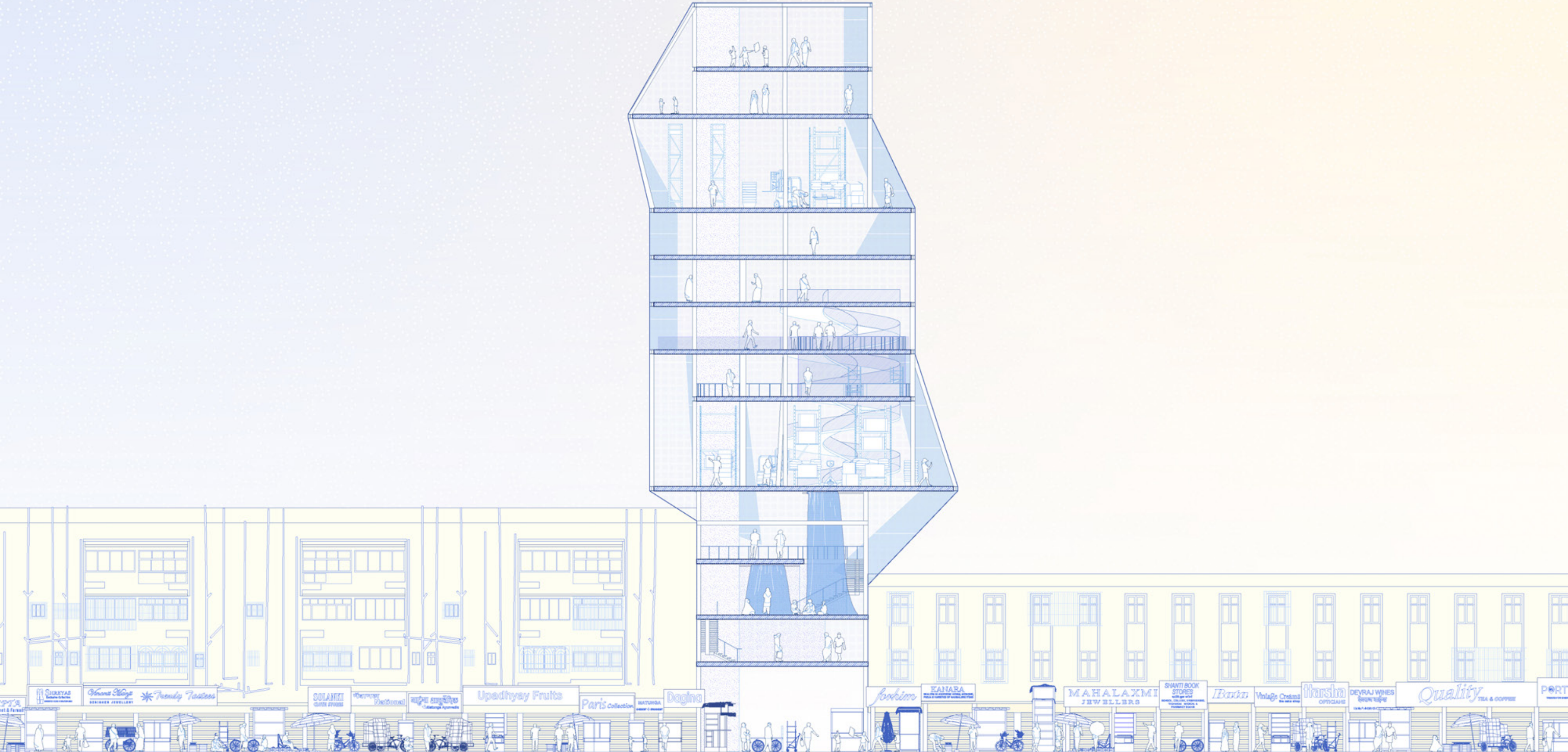

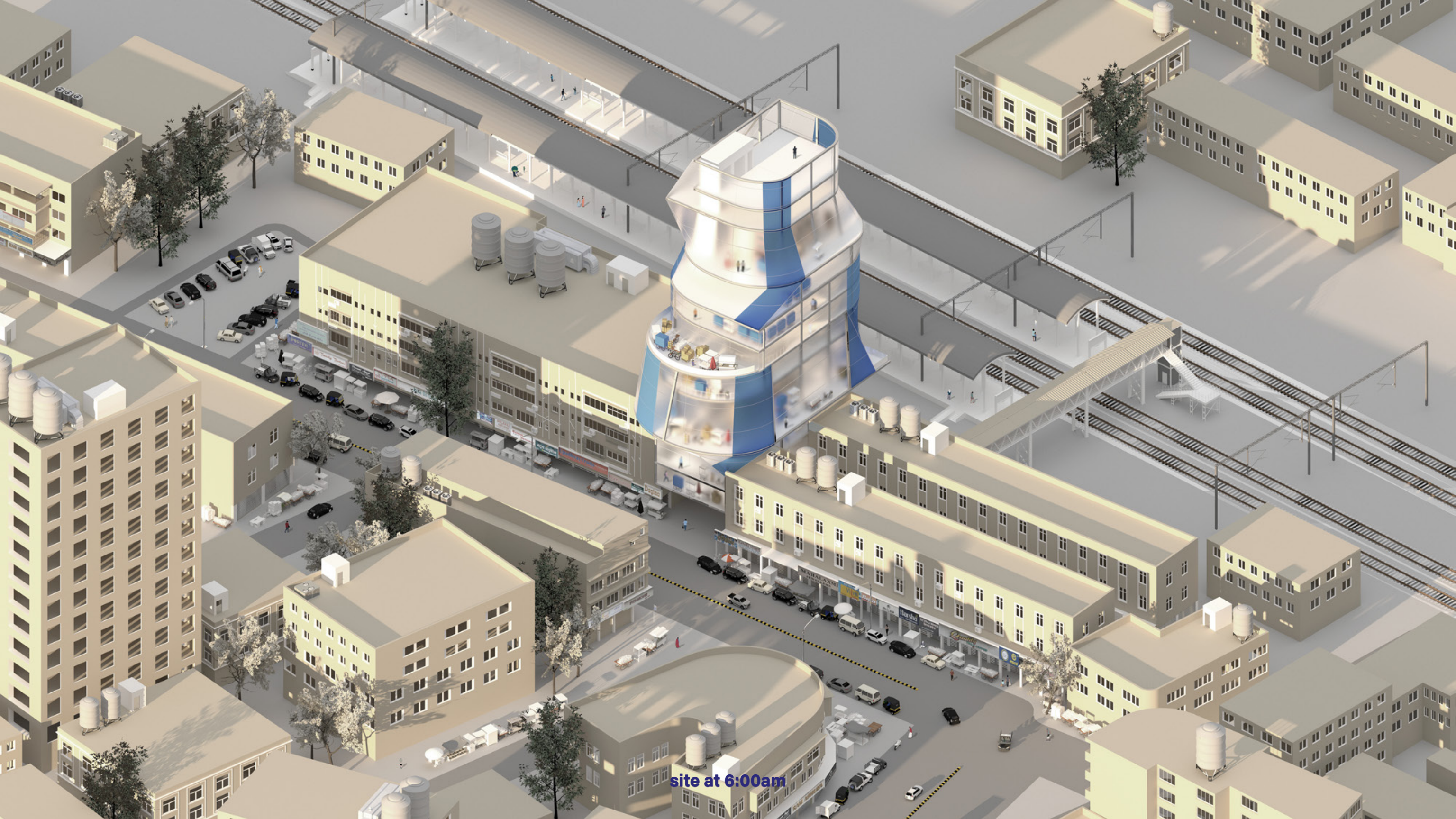

site at 6:00am



site at 12:00pm

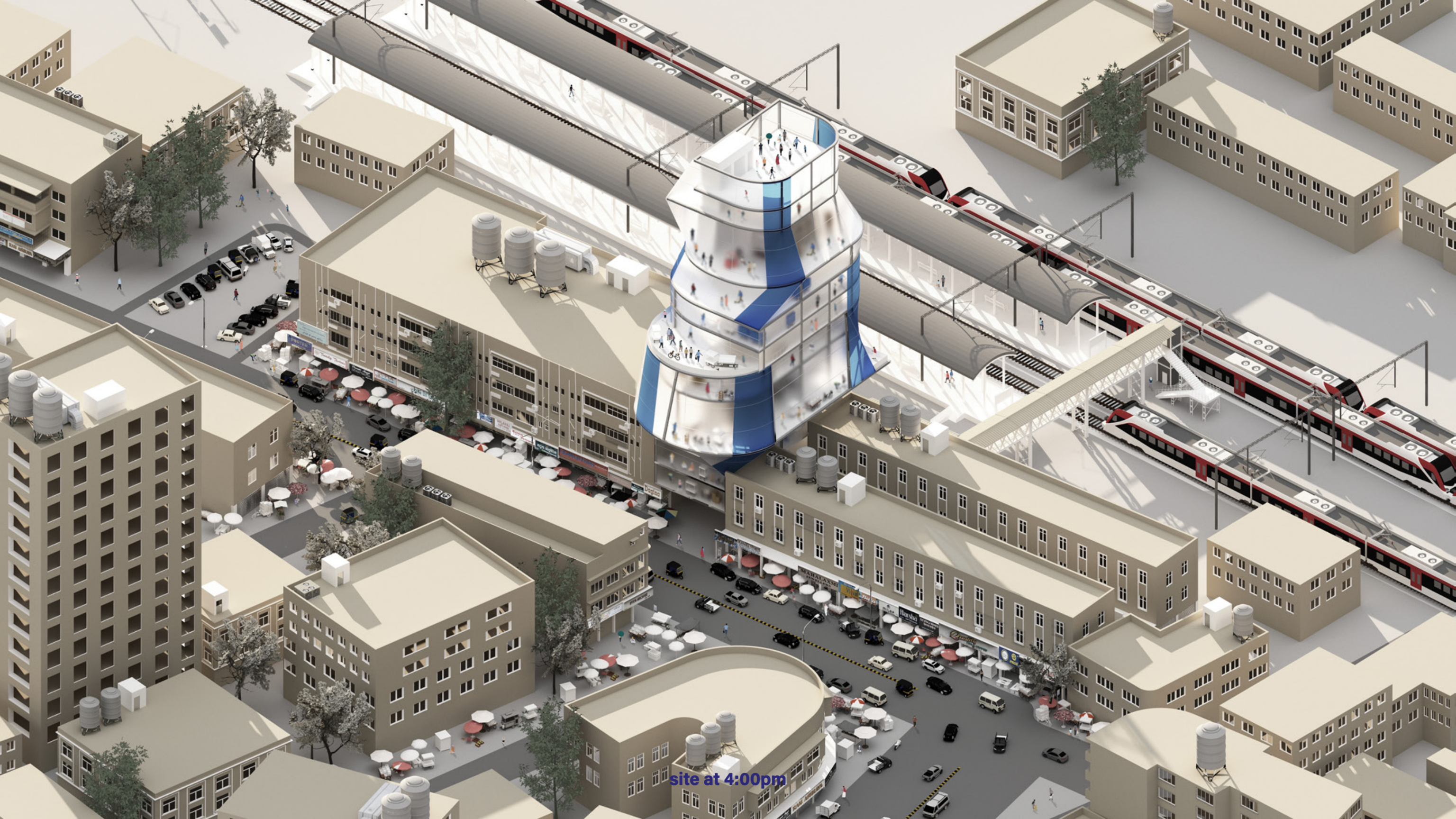

site at 4:00pm



site at 9:00pm



F& SHOPEE

D. S. CUTPIECE & R. M. SHOPPING CENTRE
श्री. एम. बरबन & श्री. एम. मीरान मॅर
HANDLOOM TEXTILES &
PUSHPAM SILKS
WEDDING SAREES

मेवाड आइस्क्रीम Mewad ICECREAM

mindless mumbai daily photo blog from mumbai, india

मेवाड आइस्क्रीम





GUPTA
गुप्ता Sweet & Parsan
खीट अंड फरसाण

Asha Dil Depot

RUSHAB INDUSTRIES
RUSHAB INDUSTRIES
RUSHAB INDUSTRIES

SUZUKI

KRM