

CONJECTURE FOR EVERYTHING

The Urban Mega-Gusture of
Retroactive Siege of Ground,
Levitative Everyday-Life ⁽¹⁾,
Rhizome of Everyday-Life ⁽²⁾

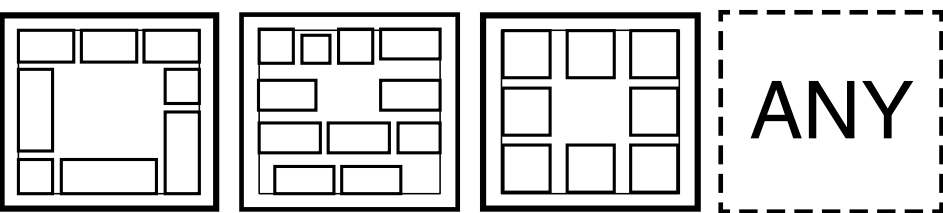



Over Flooded Brusselization x9

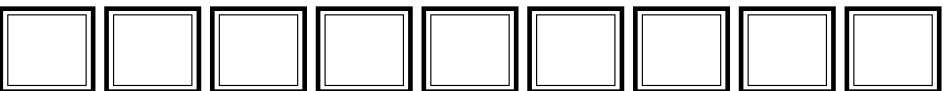

Over-grown Urban Ground x99

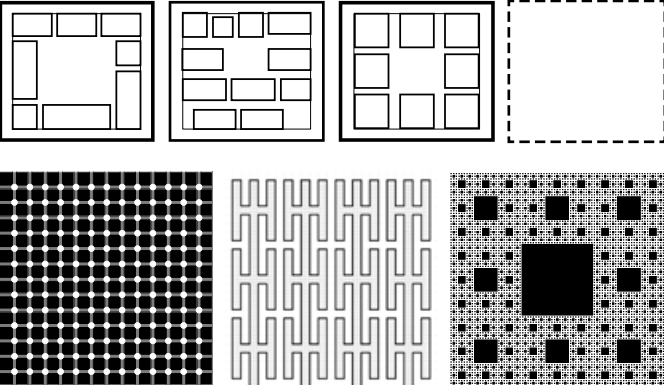
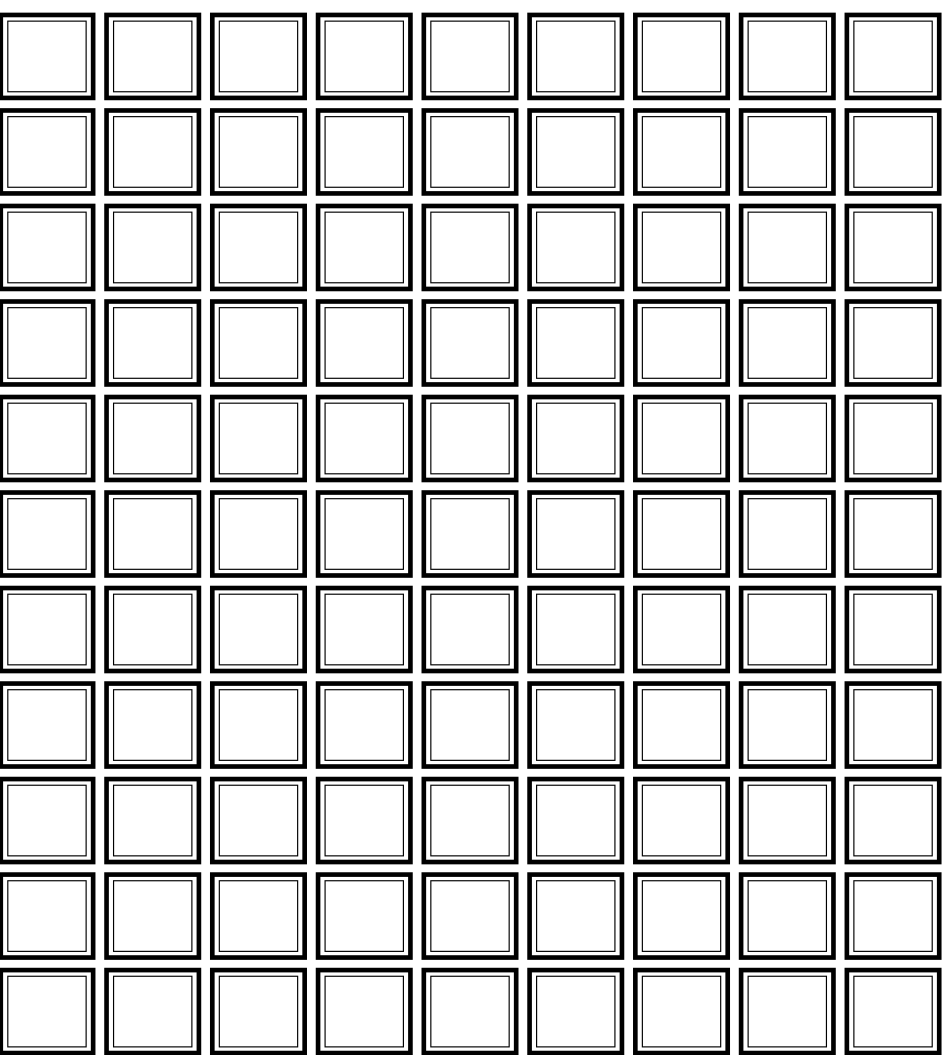

... any permutation

In a hyper-rationally planned city like Shenzhen, the city block becomes the representational instrument of will and power. The alienation of naïve forms, the social apparatus of political propaganda, the overdesigned waterfront skyline overlooking Hongkong, the miscorrelation of centers to peripheries, the Brusselization of fallaciously positioned towers...they all inform an agenda of homogeneity and representational capitalism in which social equity becomes the more generalized expression of the status quo. In the not-too-distant future, the urban ground will become consubstantial and unoccupiable.



x9,999... on top

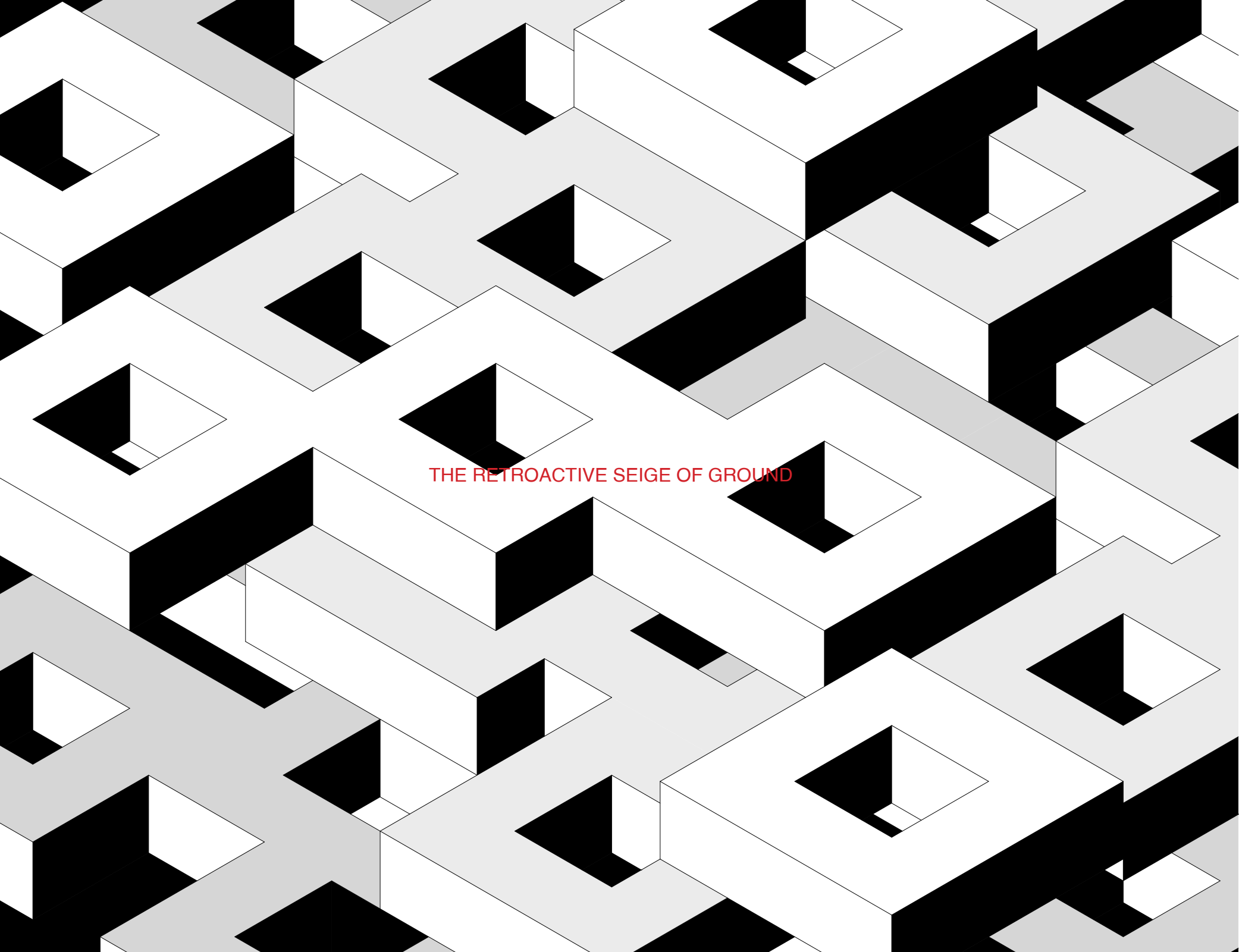
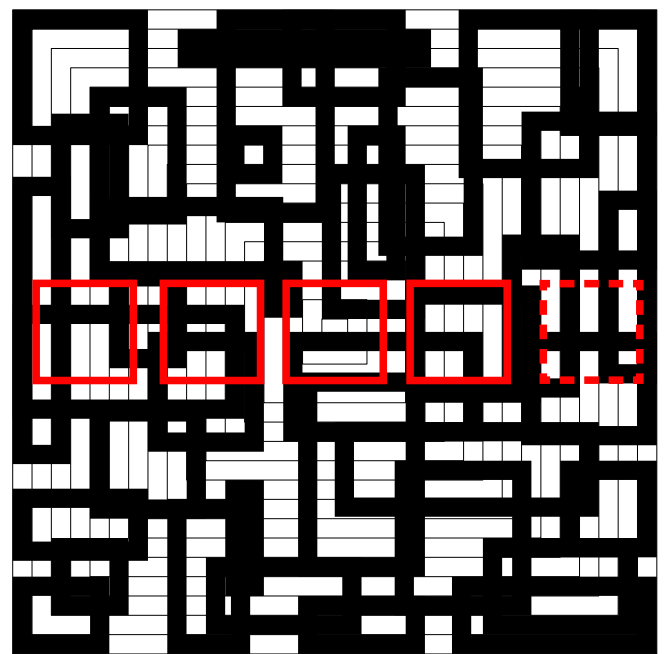

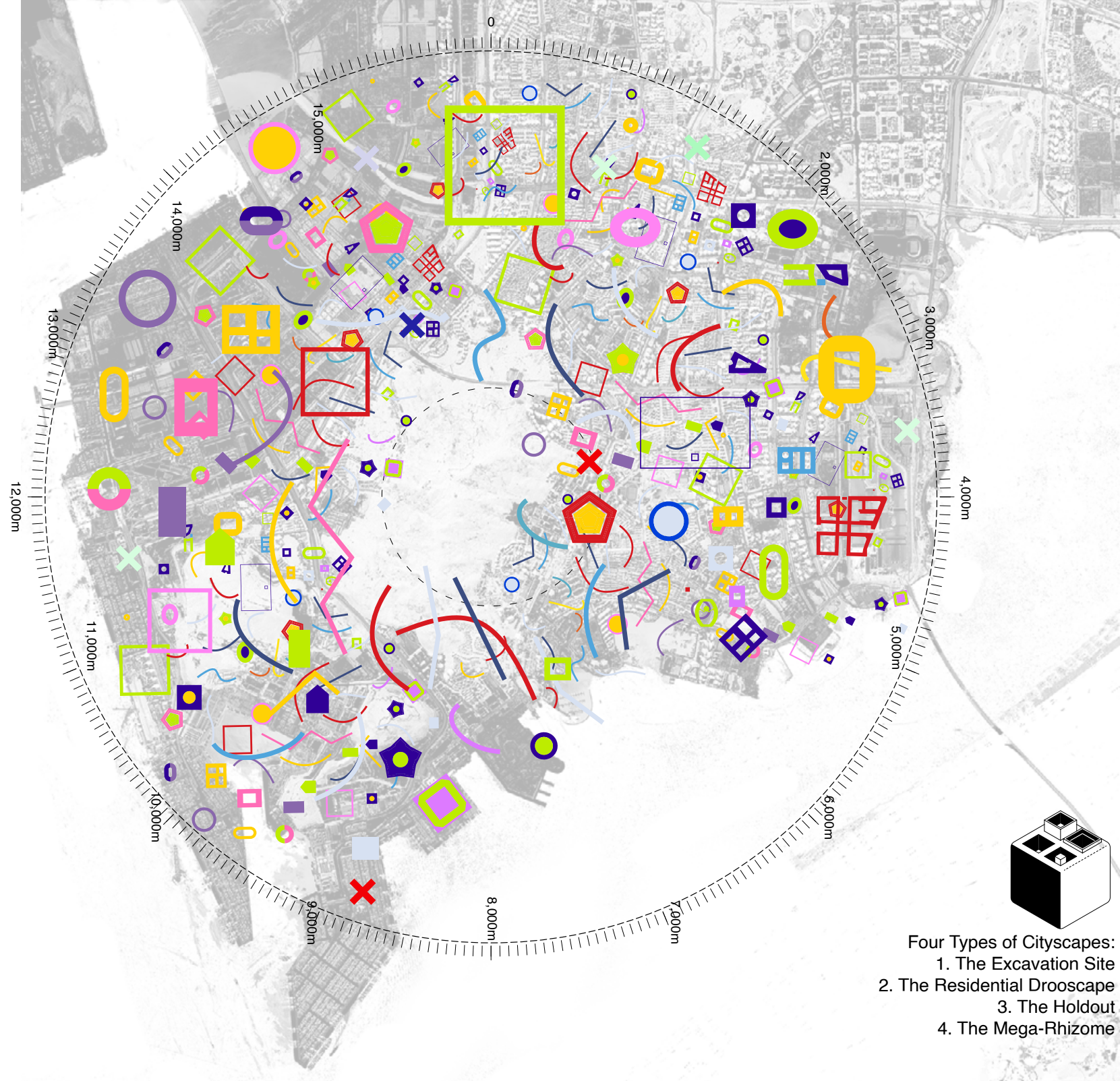

THE EXCAVATION SITE



In the not-too-distant future, the constructed ground will be commissioned over the top of the previous ground. The current ground, the old and the new connecting all the structures becomes the dust of age covering the obscure far past. An archeological excavation of the past has been carried away in the middle of the city, showing that this city is full of great wonders.



Theme Park: Window of World

As we know from today, that there is a clear mis-positioning of the deceptive objects of the Pyramids, the Colosseum, the Eiffel Tower... in a city like Shenzhen. It turns out that these wonders were replicas in a lost theme park. The iconic structures were alienated from the everyday life, yet connected closely with a planned pattern.



Replica: The Great Pyramid of Giza



Collapsing to Urban Singularity

METHOD OF DIVISION (of street blocks); ACT OF REVEALING/ CONCEALING

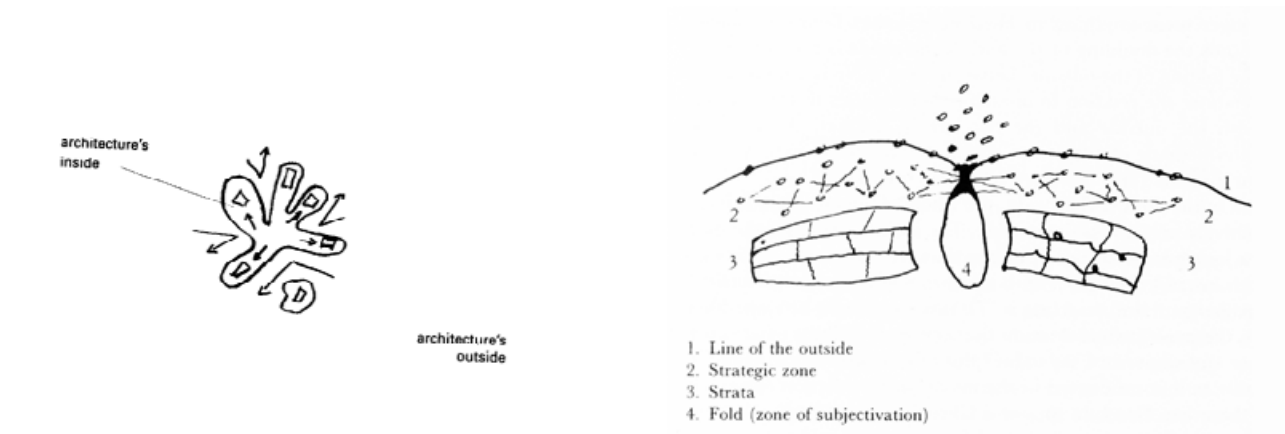

Extroversive semi-courtyard

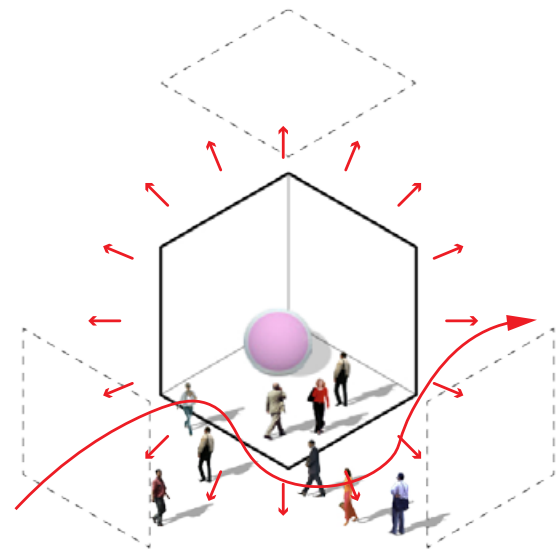

semi-Extroversive semi-courtyard

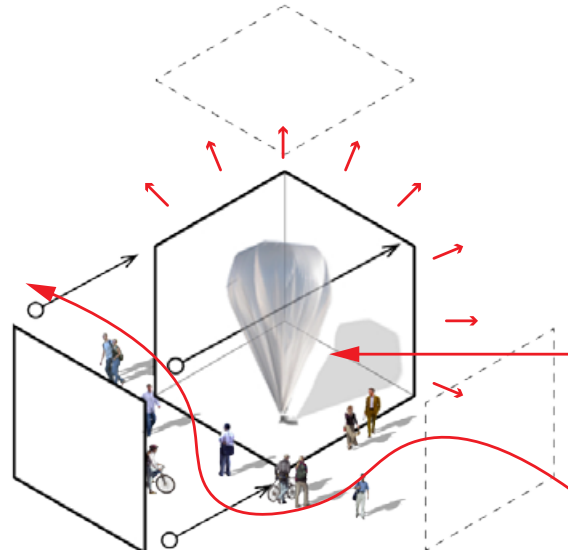

Introversive courtyard

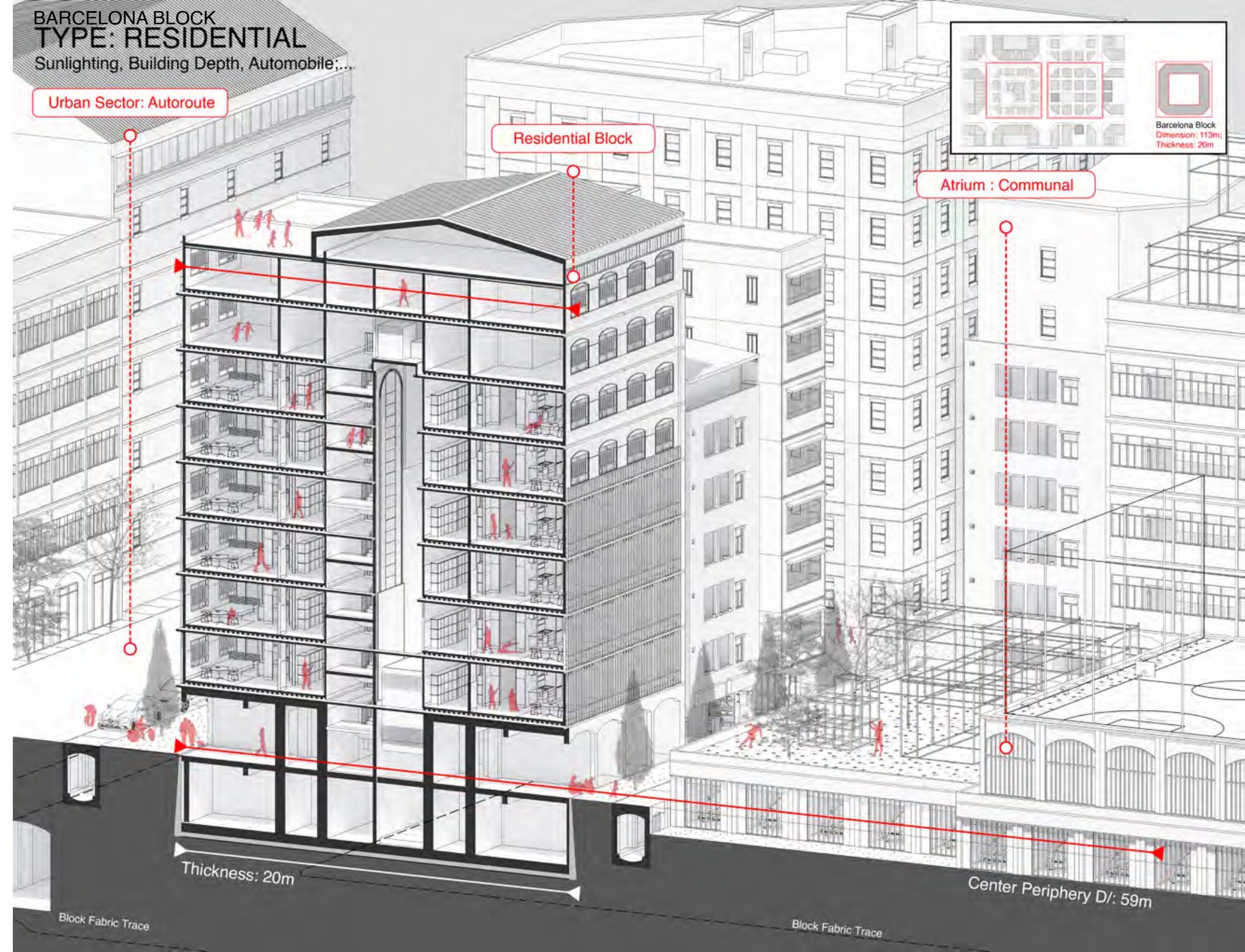
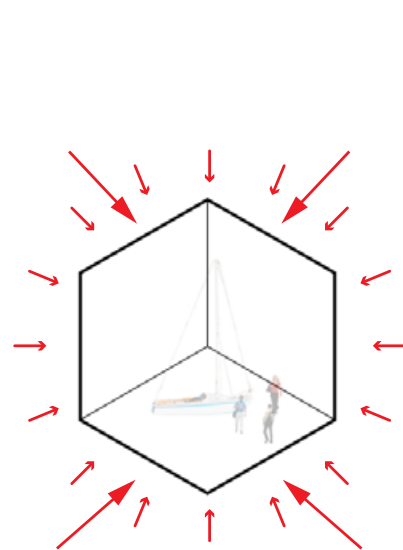

PATTERN OF DELINEATION FROM A MONOCENTRIC BLOCK TO A MULTI-CENTRIC BLOCK

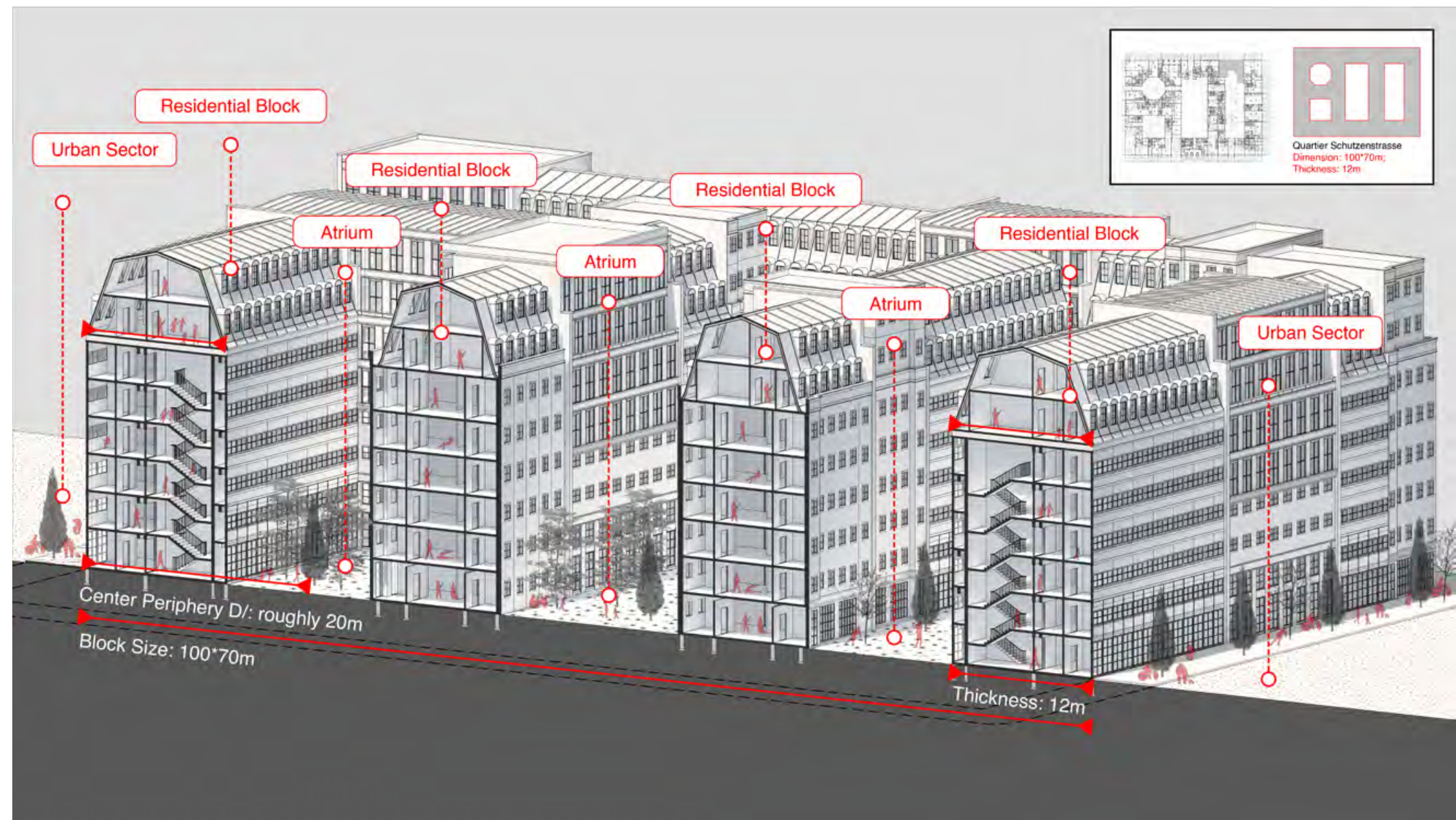
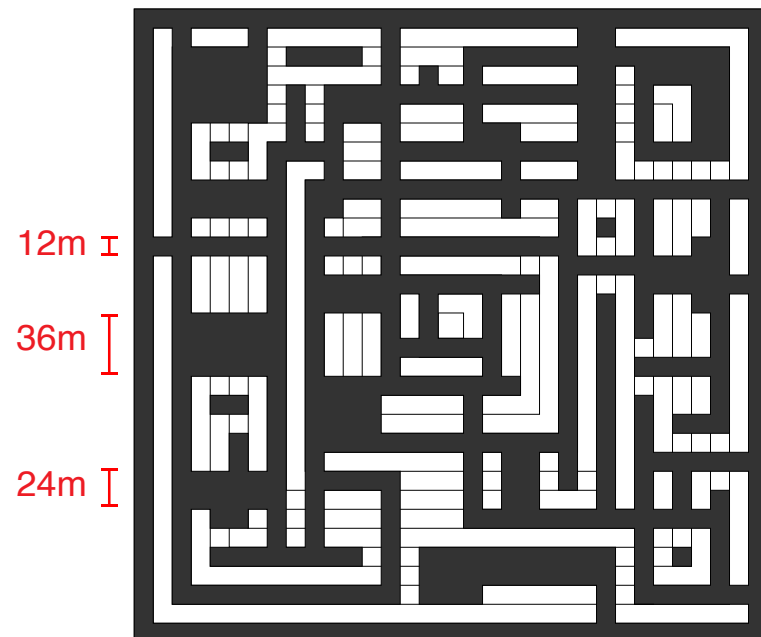
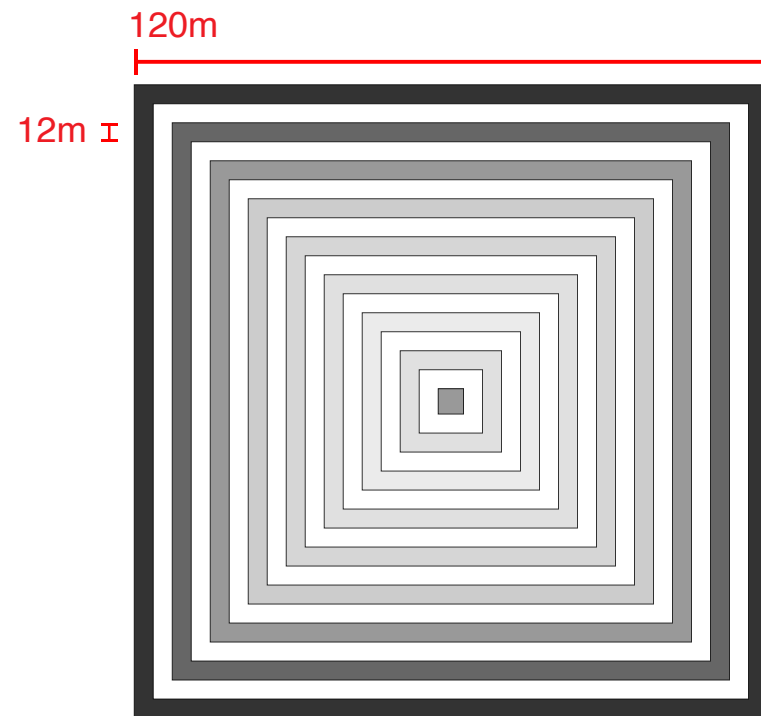
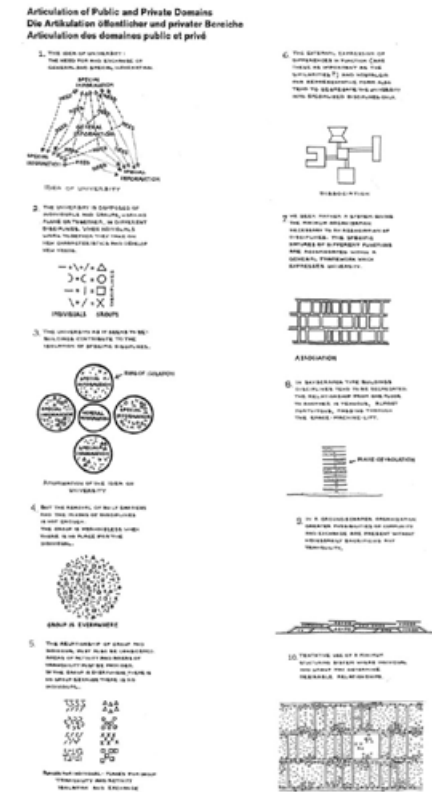
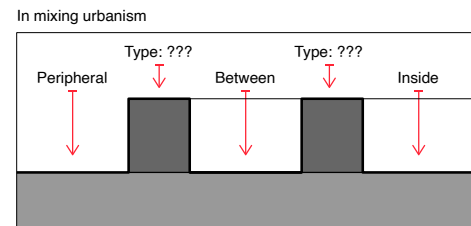
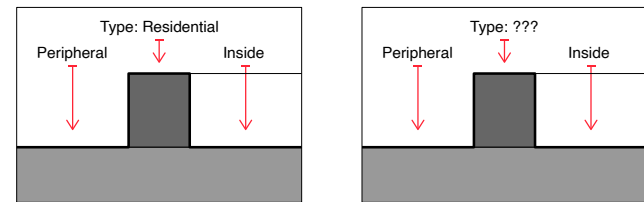

Aldo Rossi and IBA Berlin
The Quartier Schützenstraße has a camouflaging exterior: A consecutive structure with colliding styles on the surfaces, The definition of architecture, and the definition of ground becomes blurry, together catalyze the amalgamation into a **Megaform**.

DEVELOPMENT OF THE PATTERN INTO THE RETROACTIVE CITYSCAPE

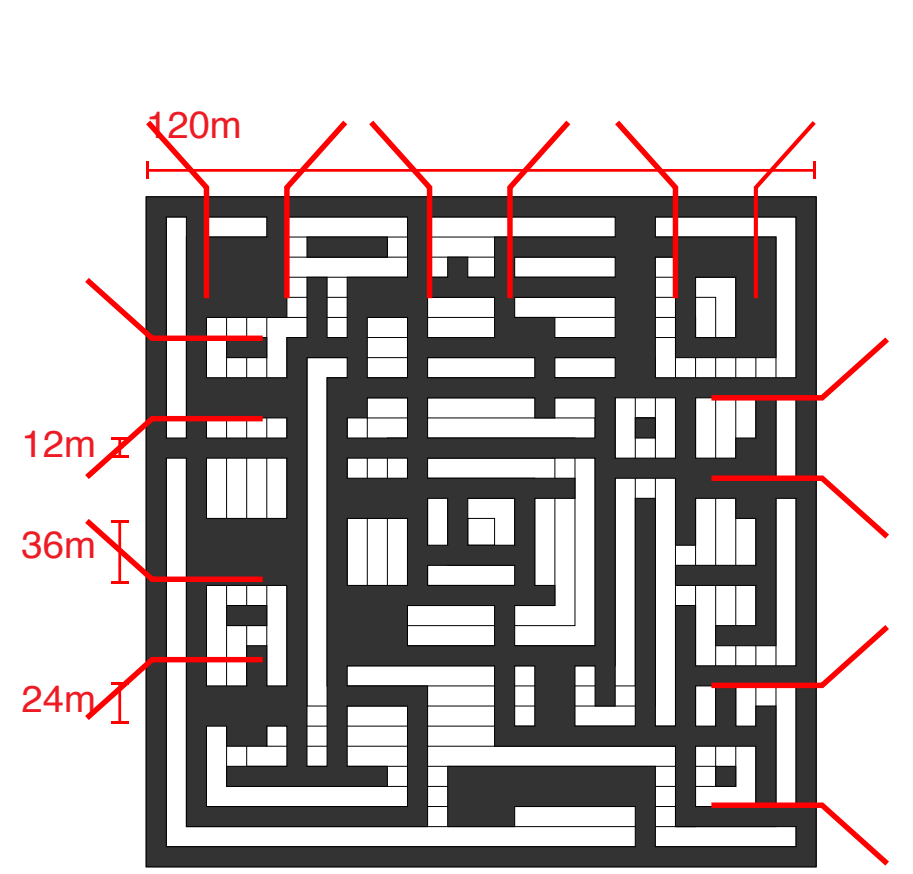

Extroversive semi-courtyard

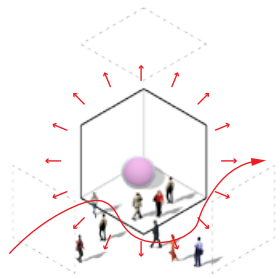

semi-Extroversive semi-courtyard

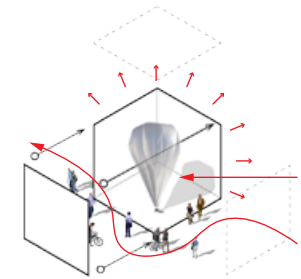

Introversive courtyard

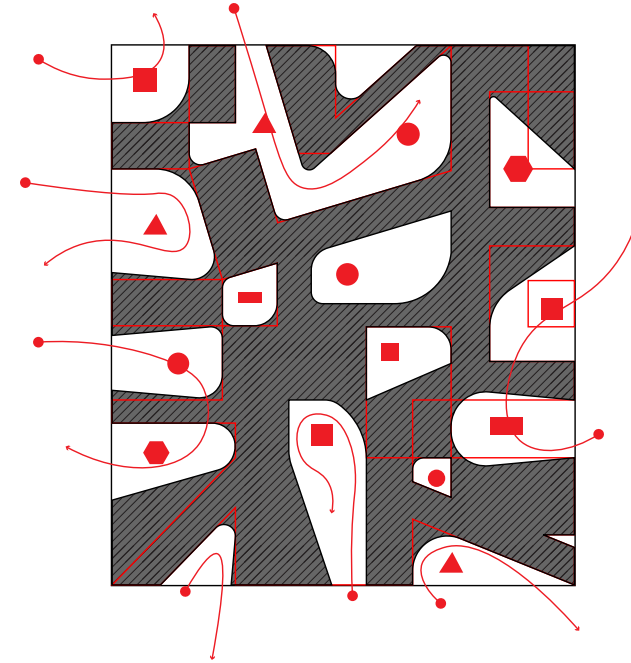
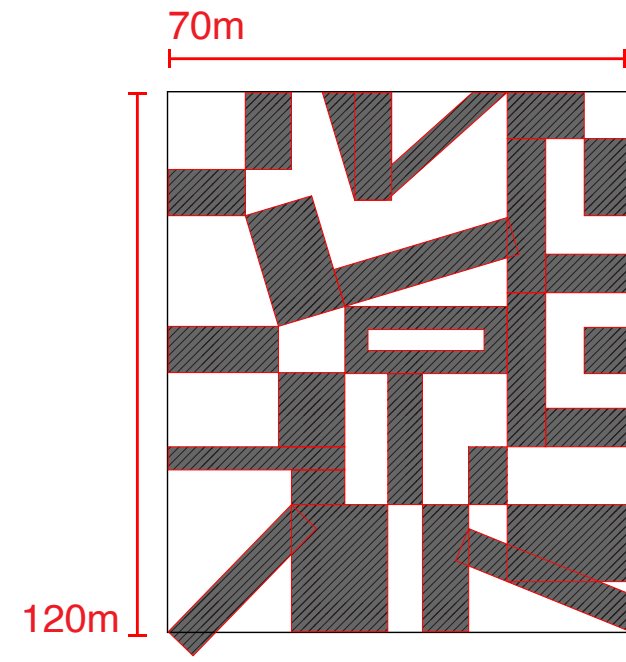
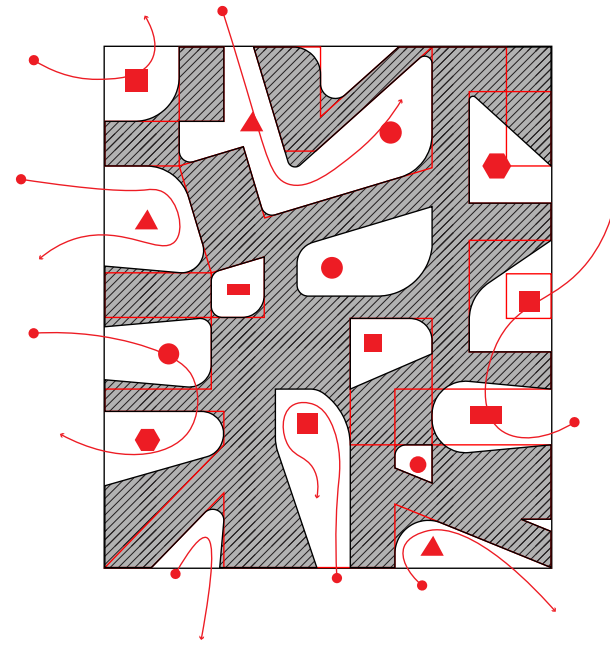
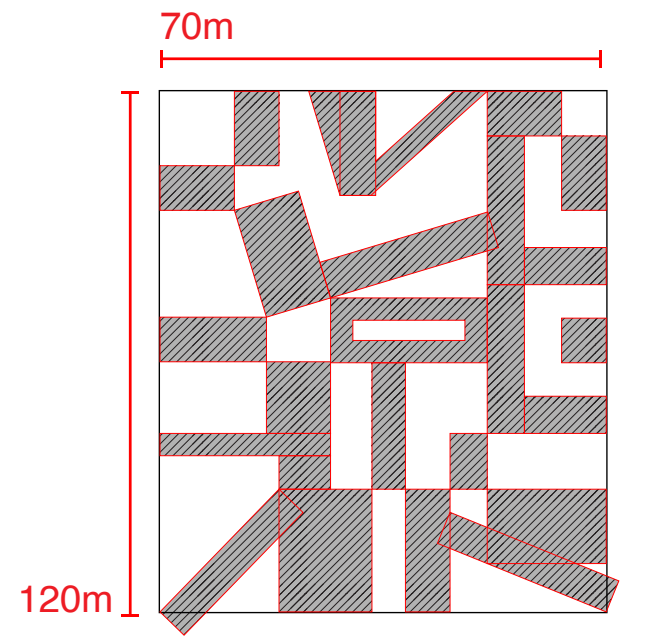
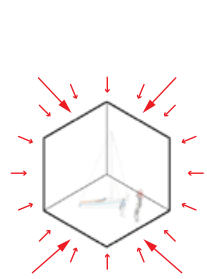

RETROACTIVE ENTROPY INCREASE

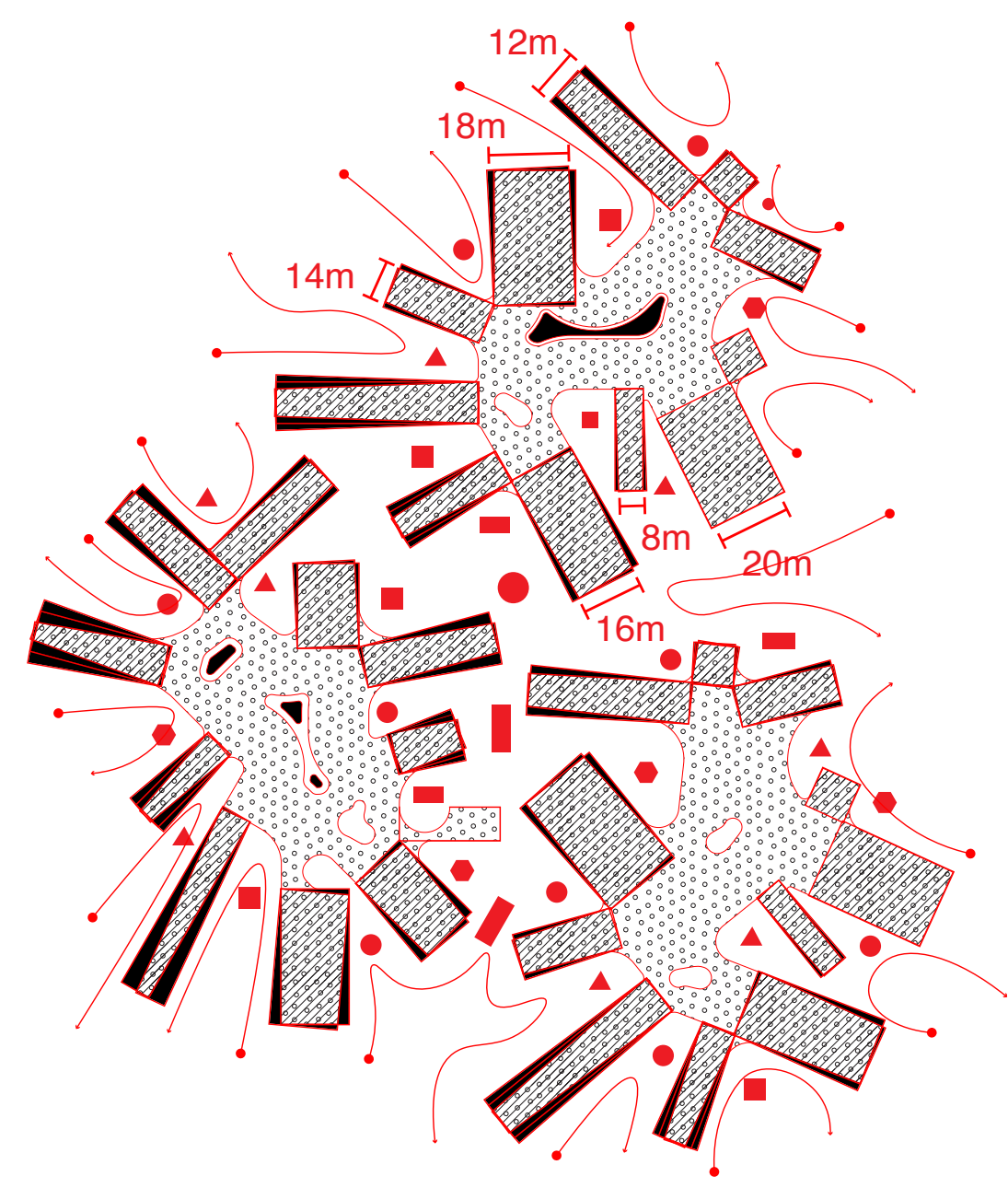



THE RESIDENTIAL DROSSCAPE

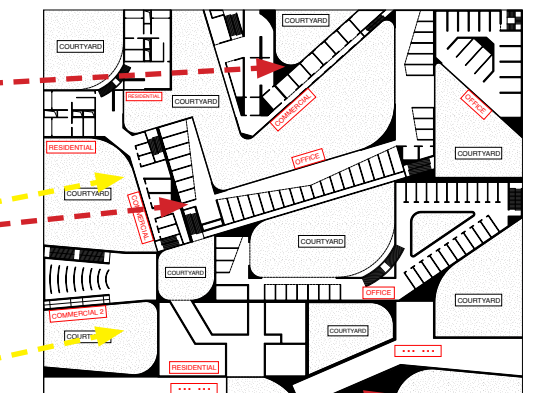

Consustantial District



Consustantial Ground

AMALGAMATION OF GROUNDS AND RETROACTIVE FORMS



Agenda of Homogneity

The alienation of naïve forms, the social apparatus of political propaganda, the overdesigned waterfront skyline overlooking Hongkong, the miscorrelation of centers to peripheries, the Brusselization of fallaciously positioned towers...they all inform an agenda of homogeneity and representational capitalism in which social equity becomes the more generalized expression of the status quo. In the not-too-distant future, the urban ground will become consustantial and unoccupiable.



Brusselization

From a retroactive aspect of forms in the city, these issues could be dissolved by their own visual implications. However, the uneven speed of form distribution could result in over-growing of city parts.

THE RESIDENTIAL DROSSCAPE

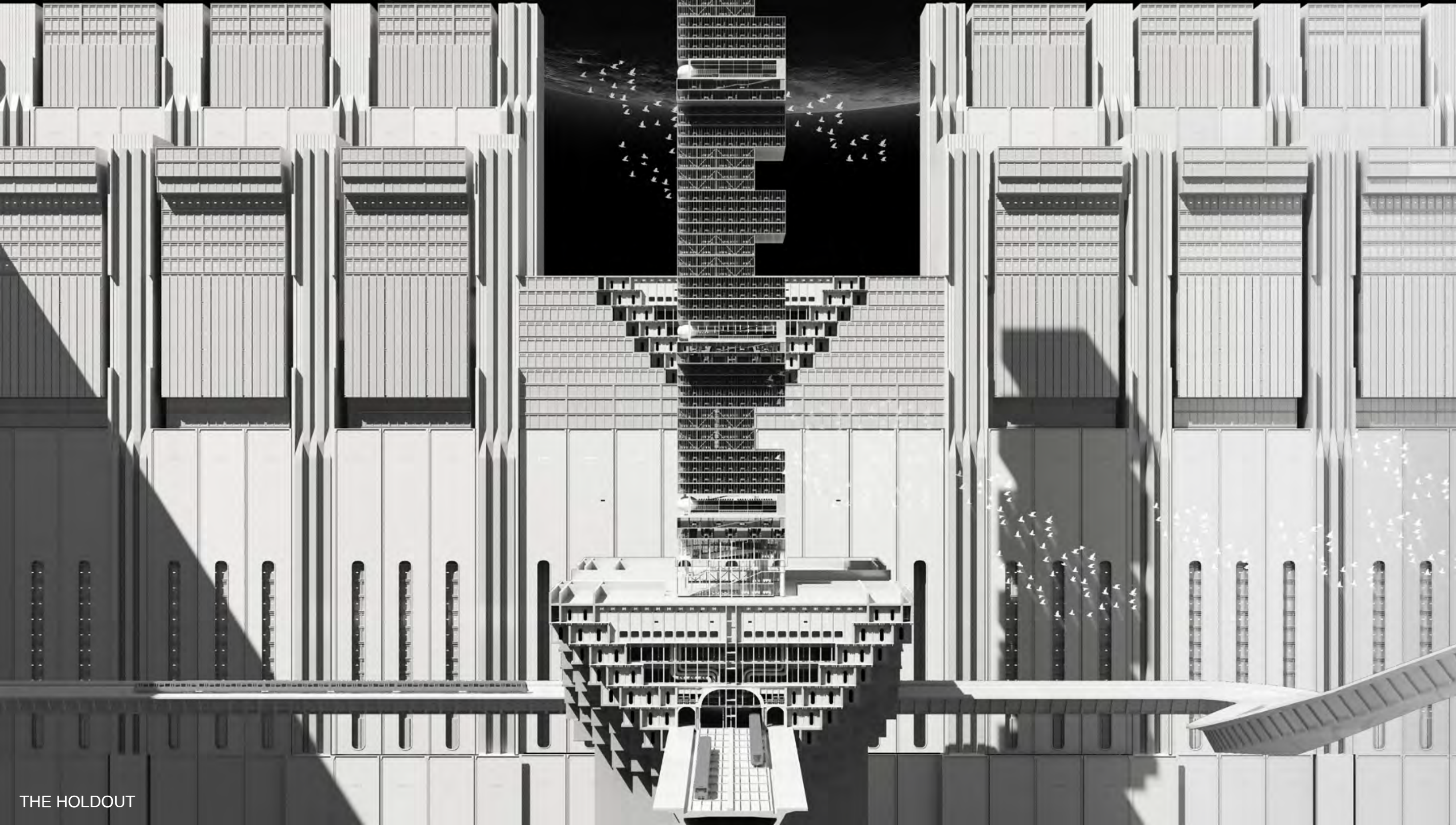

THE HOLDOUT



Holdout
 Pinning (unpinning) the legacies of the cityscapes. The surrounding devouring the little past of history.

Saturn Devouring His Son
 by Francisco Goya



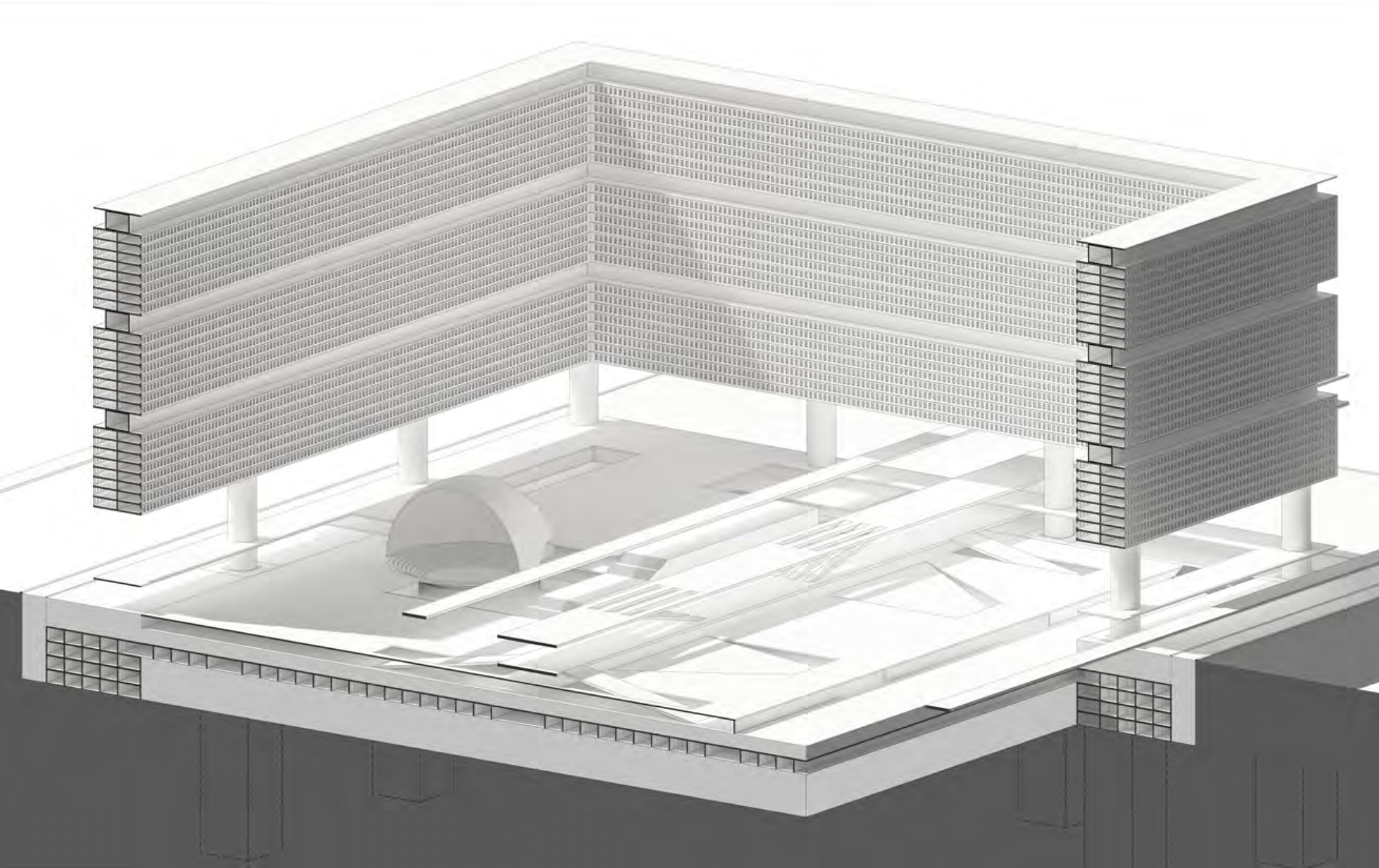

Centro Direzionale: High Wall, Elevated Structure, Grounds.
 A powerful nature to the eye of naïve encircle of structures, the strong expression of political delineation. The center
 is an open courtyard of multi-leveled grounds of mundane.

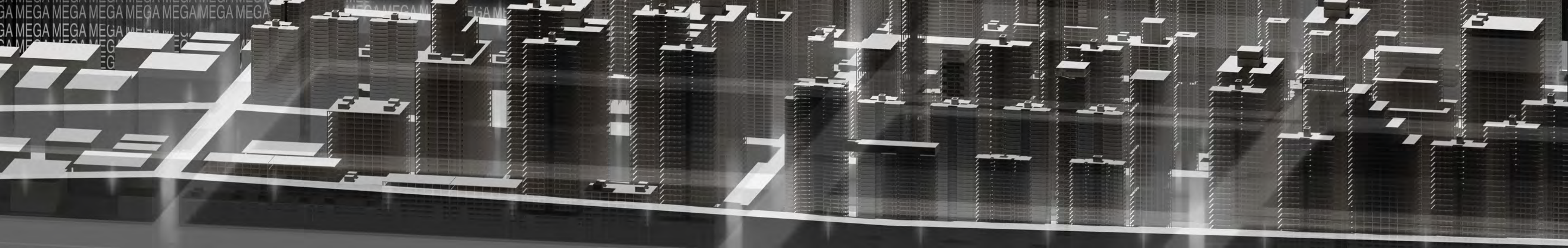

Overreaching of Power

The overreaching of privacy, identity of blocks, therefore, the overreaching of bounds unleashed by street blocks

Manifesto of Block Identities (Horizontality)

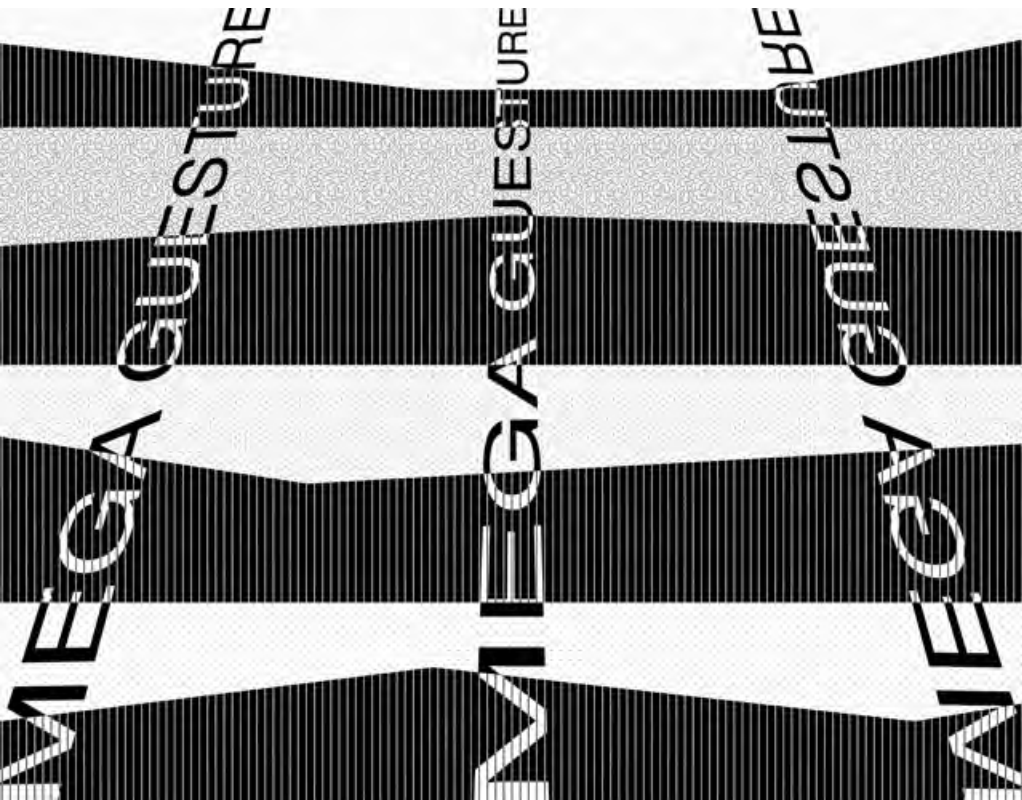

Megaform as New Streets

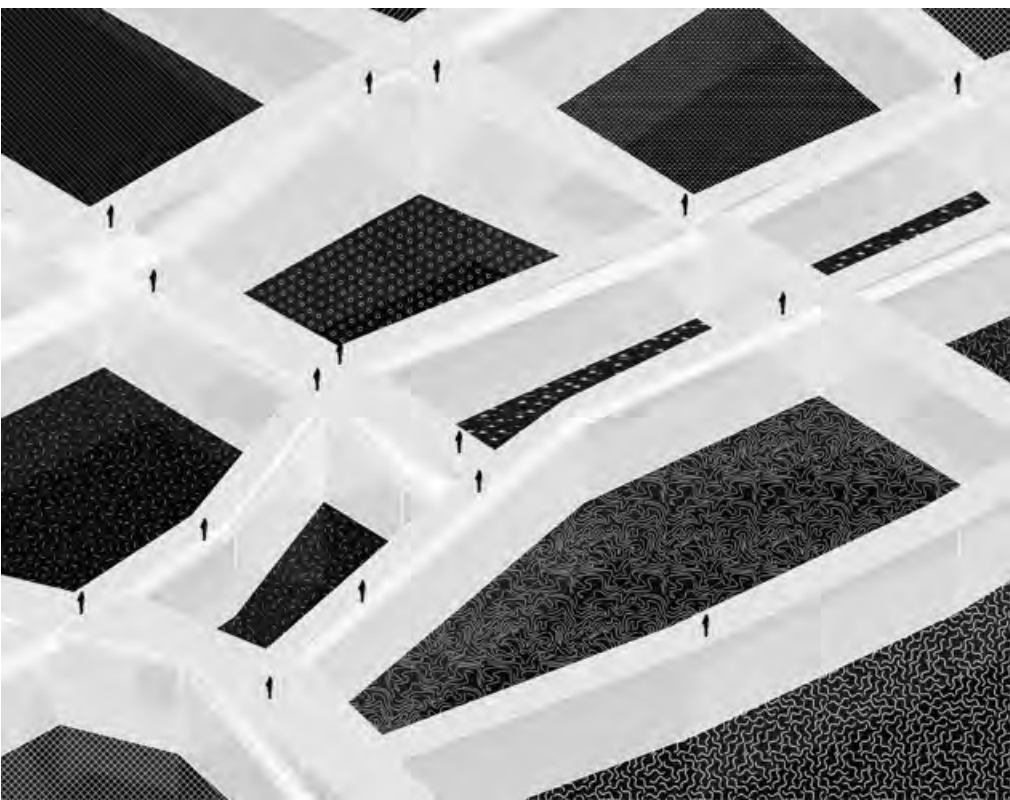

The Analogous Megaform in Verticality

The Walls of extruded streets are determined and pushed upwards and downwards, in a city that is gradually losing the ground. Everyday Life depending on more personal and infrastructural are bounded in the urban Mega gesture.

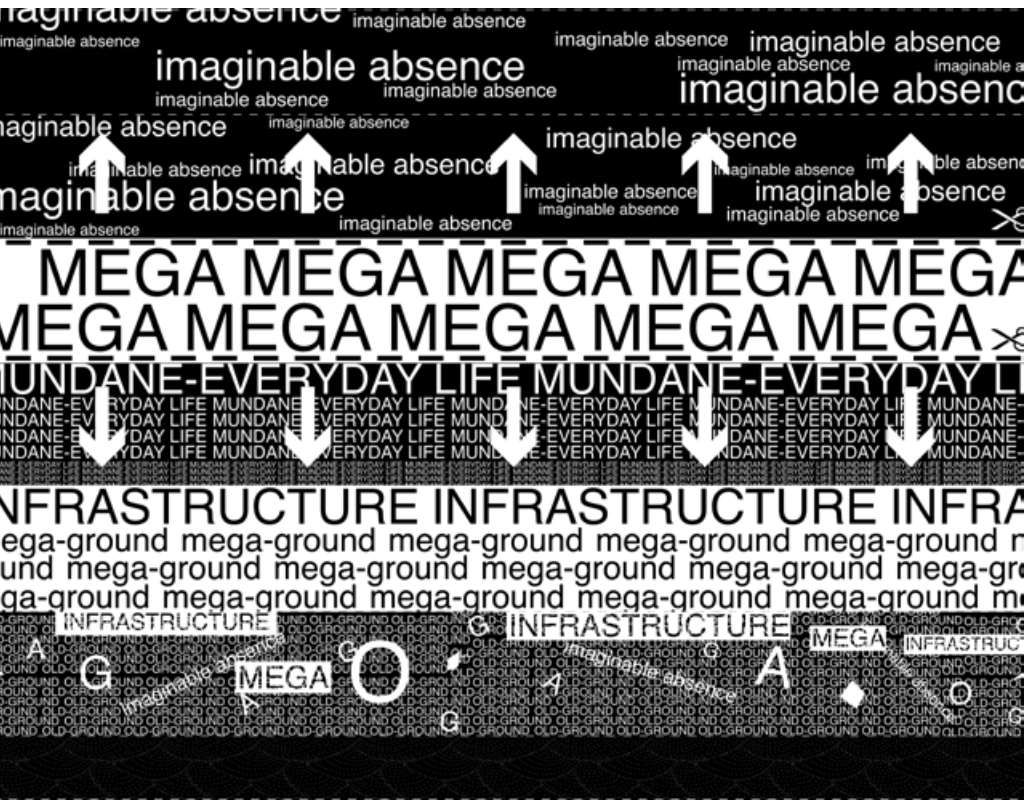

The “MEGA” Carrier of Everyday Life ⁽¹⁾

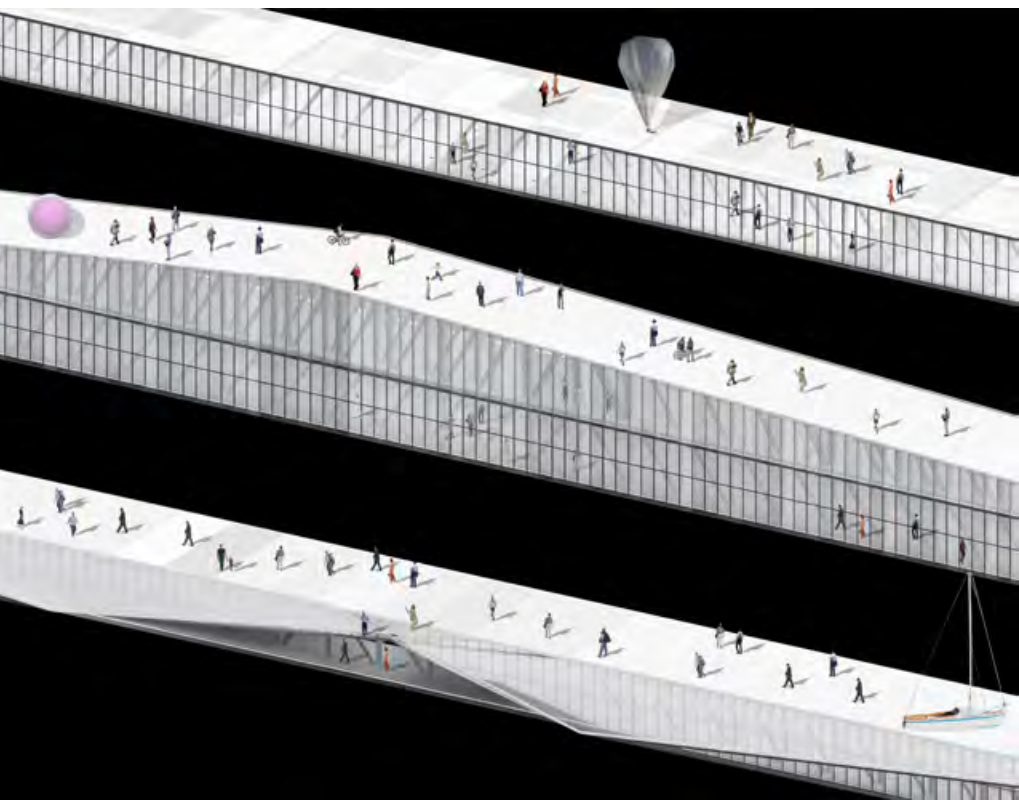

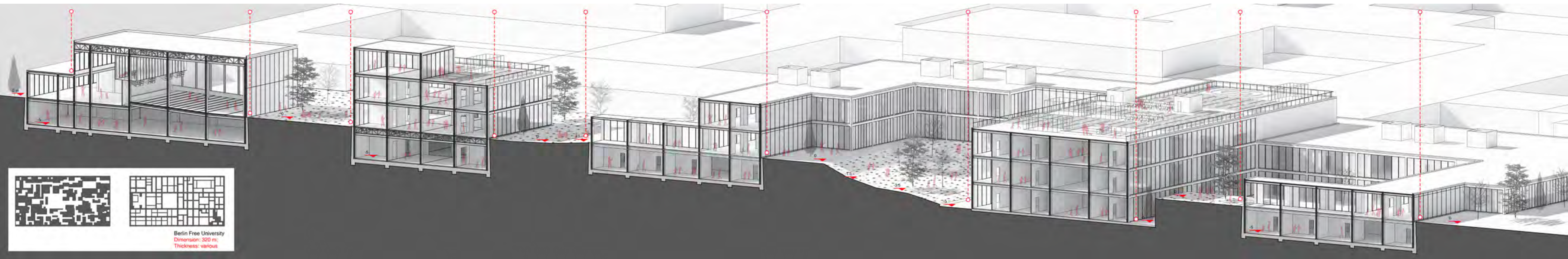

As a countermodel, the primitive order of the city is relentlessly devoured by the retroactive siege of the ground unleashed by the urban megaform: the courtyard block, the megablock, the Apple Campus, the Pentagon, Rossi's Centro Direzionale, the IBA projects (and even the Berlin Free University as a porous rhizome of micromegaforms). Overcoded by a formal relationship

between a central void and a thick periphery, the horizontal surface is subverted by an analogous politics that reinvents the cityscape.

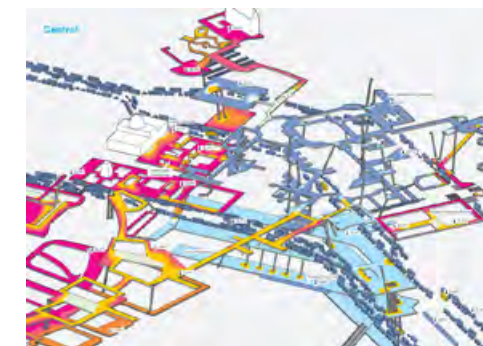

“City without a Ground”

The design undertook the task to differentiate grounds in a city without a ground. The delineation is multi-dimensional.

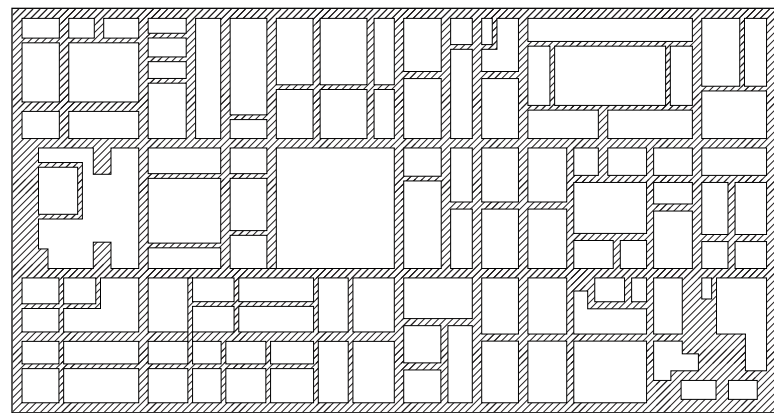
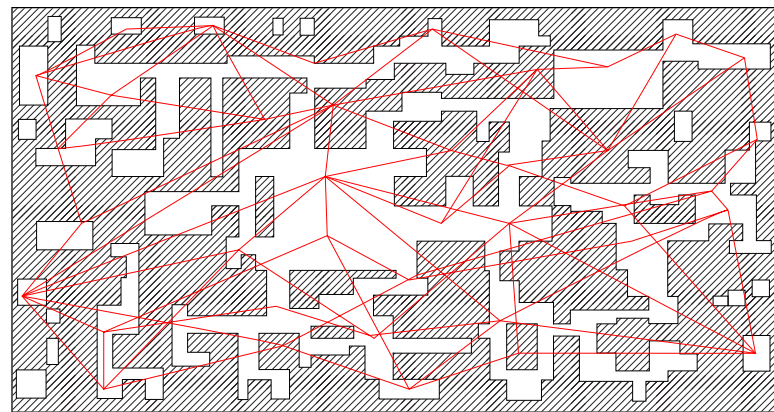
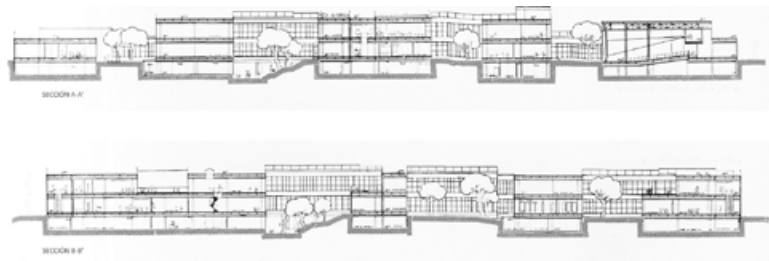

Articulation of Public and Private Domains Die Artikulation öffentlicher und privater Bereiche Articulation des domaines public et privé

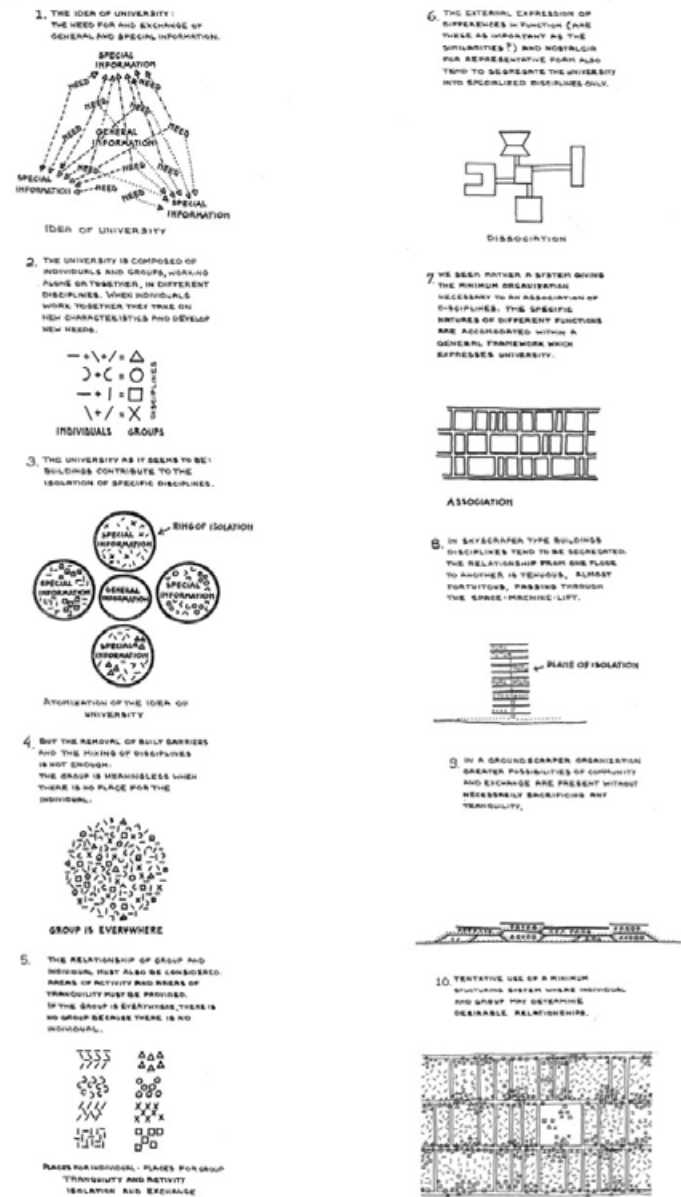

Mega without a Ground
The grounds for everything in everyday life.

Reenabling streets with the Politics of Megaform
The porous identity of street-block-street pattern.



THE ONEROUS MEGA-RHIZOME

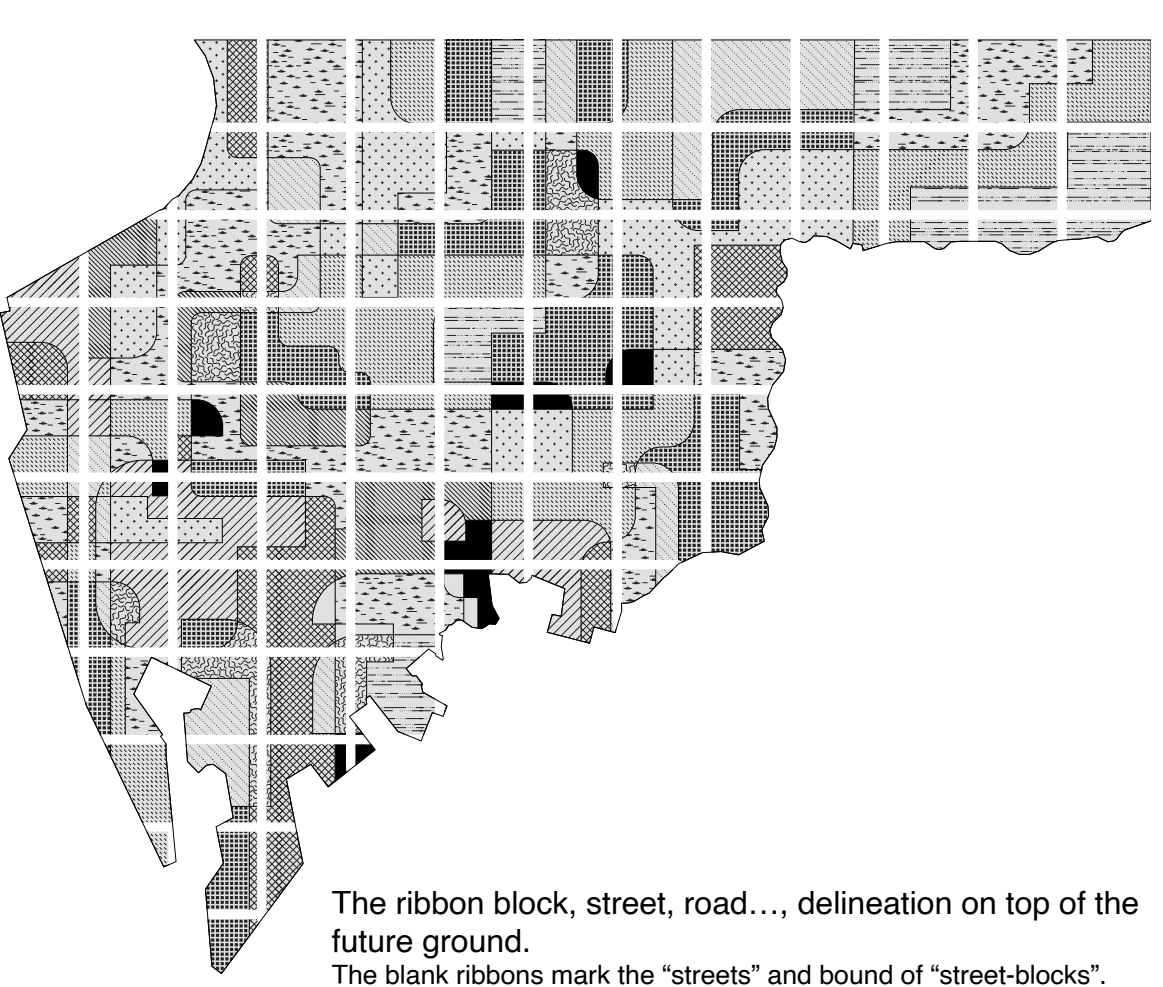

The ribbon block, street, road..., delineation on top of the future ground.
The blank ribbons mark the “streets” and bound of “street-blocks”.

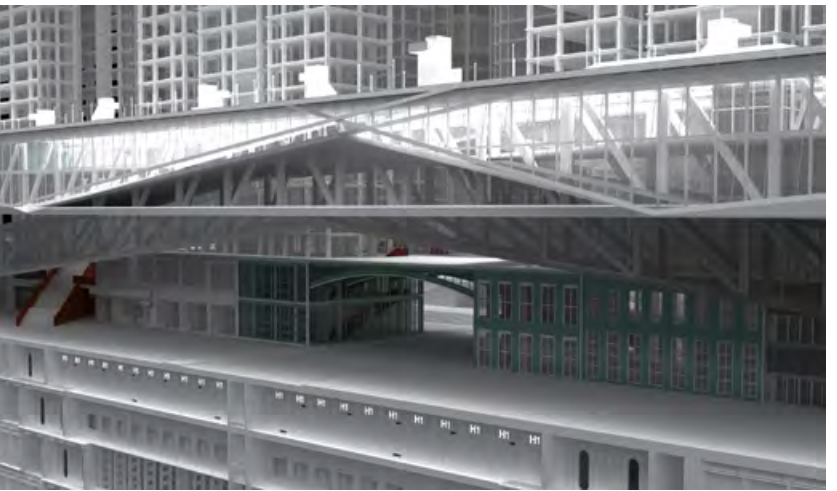

Street view watching a segment of the Mega sequence
A “bridge” in the sequence.

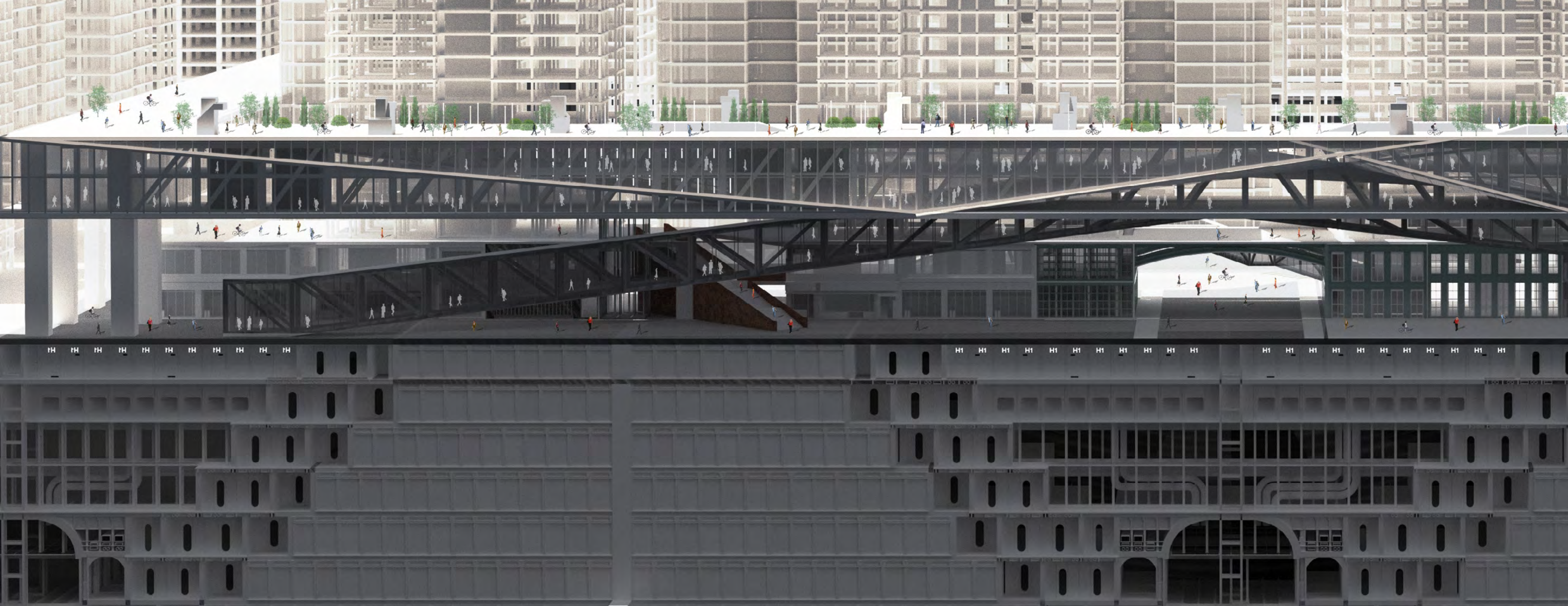

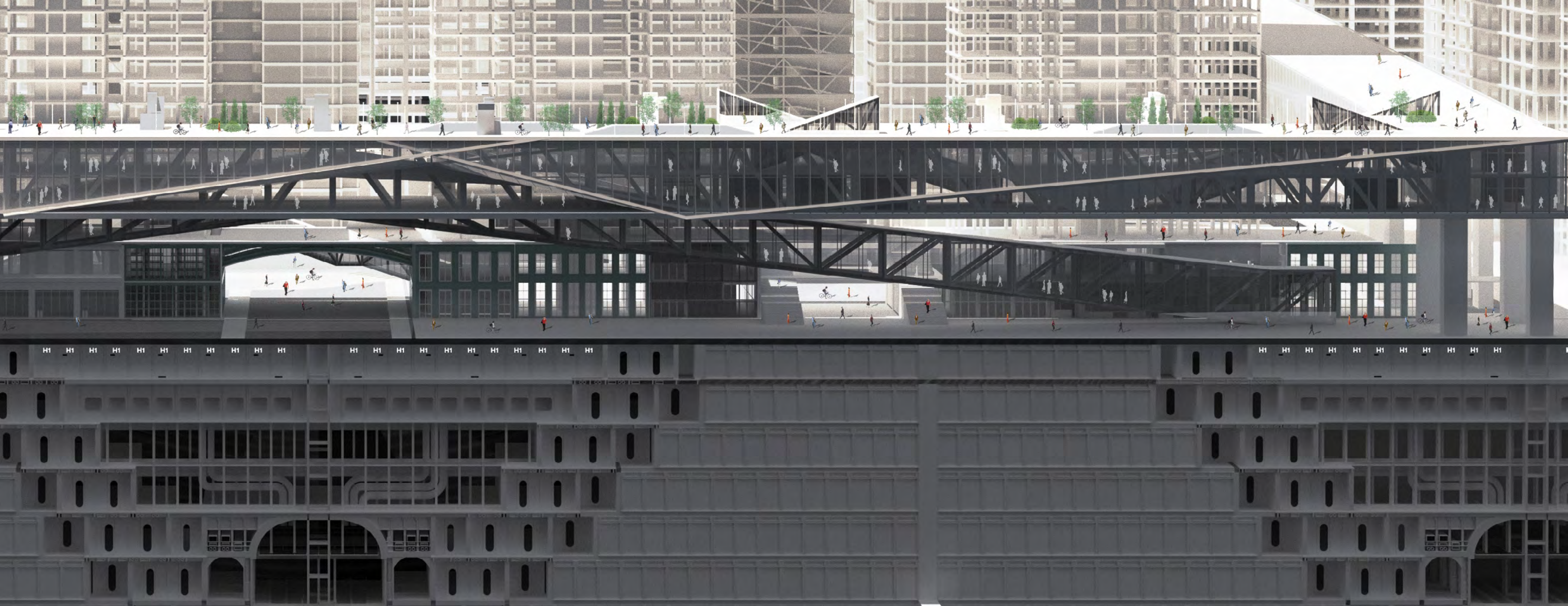

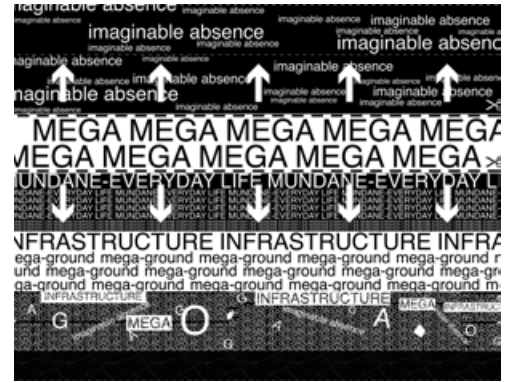
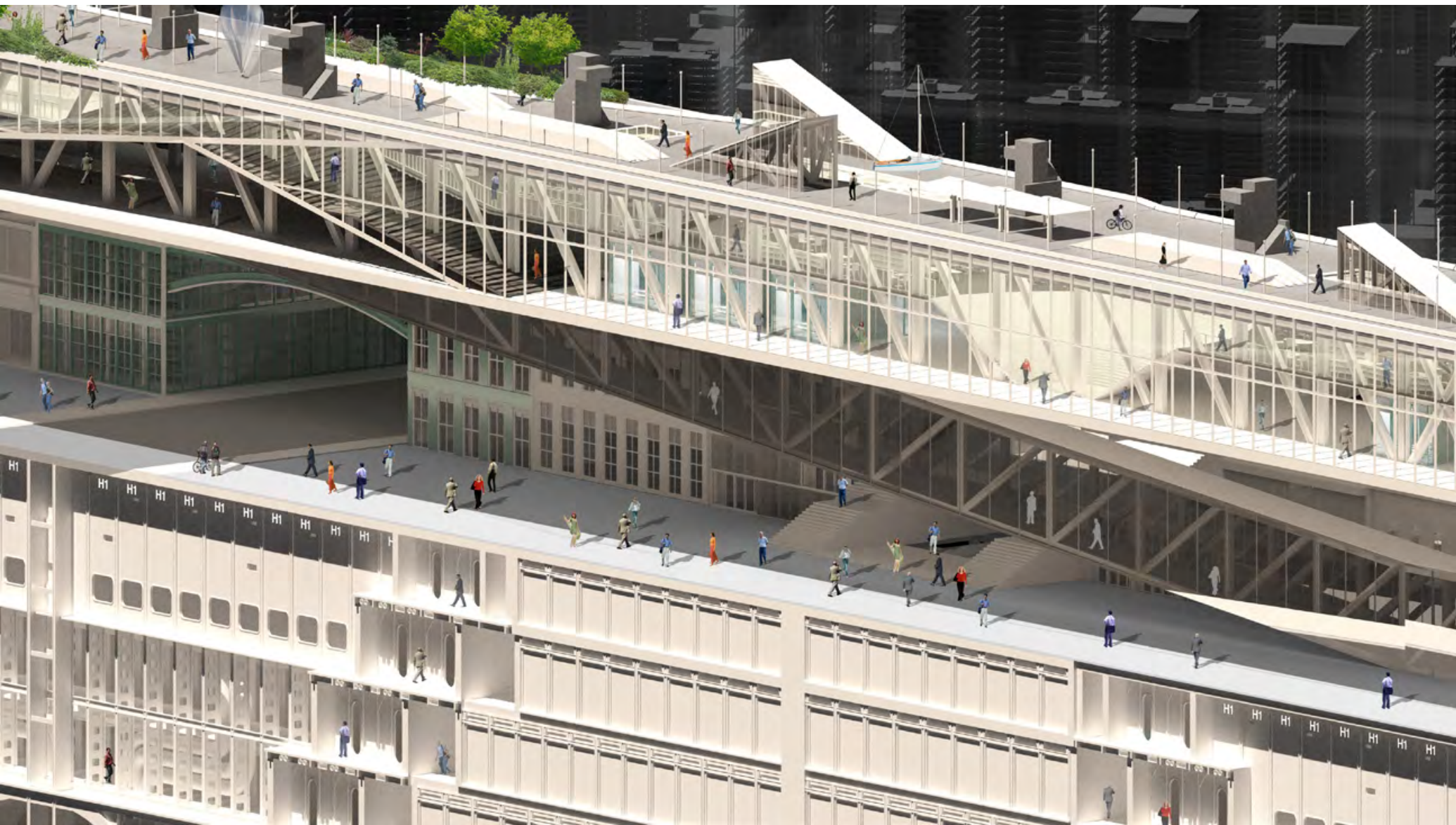
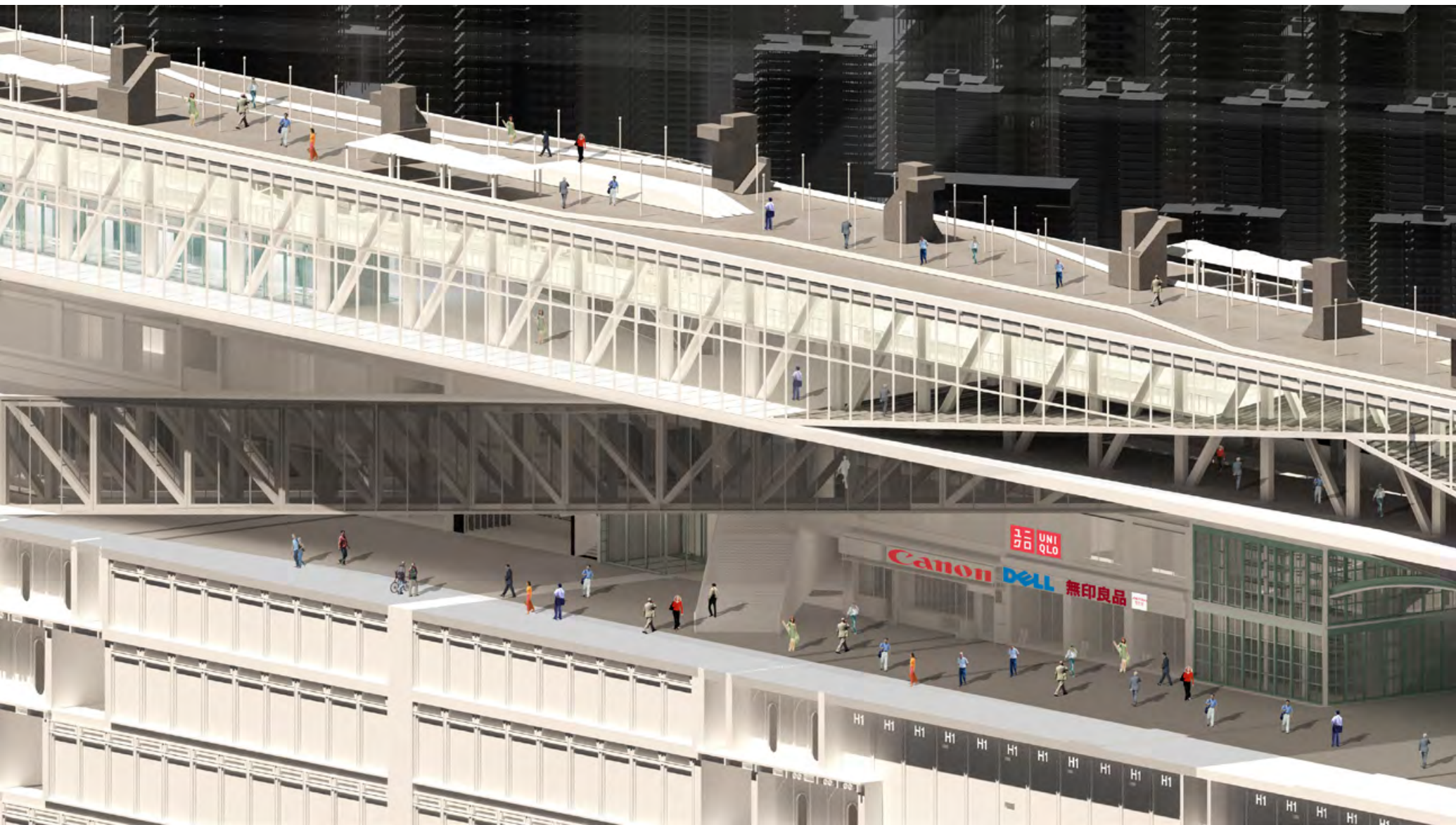

- “air”
- Analogous Street **MEGA**
- Decaying Street
- Infrastructure + Analogous Ground **MEGA**
- “ground”



Ramified Streets on top
 The different pace of everyday life named a web-formed parameter to define the analogous streets. Which can be others.



A Day at the Streets
 To navigate yourself in an analogous street; the streetscapes are the ramification of different styles of walking and purposes, therefore, the functional implication informs the location. Each block becomes a cabinet of lifestyles, the analogous street makes the place a zoo to explore the variations, while out of the street, the levitated ribbons keep the inner ground out for imaginations.

Take a Stop by the Cafe...
 Street Café inhabited in the Megaform is a slower place to stop by, this is located on the second level of the street. The upper level is a meandering esplanade for even slower walking.

